

Client:	BLOOR HOMES	Drawing No:	527699__
Site:	FARINGDON, PARK ROAD, HA	Revision No:	
House Type:	CLASSIC 3B5P SORLEY - EXC UTILITY	Scale:	Scale-to-fit
House Type 2:	RENTED		



THIS DRAWING AND THE COPYRIGHT THEREIN IS THE PROPERTY OF THE SYMPHONY GROUP PLC. THIS DRAWING IS ISSUED ON THE CONDITION THAT IT MUST NOT BE USED, COPIED OR EXHIBITED WITHOUT THE WRITTEN PERMISSION OF THE SYMPHONY GROUP PLC. ANY COMPONENTS OR ARTICLES MADE IN ACCORDANCE WITH THIS DRAWING MUST NOT BE USED FOR ANY OTHER PURPOSE THAN FOR WHICH THE DRAWING IS ISSUED.

THIS PLAN IS OFFERED AS A GUIDE ONLY FOR APPROVAL BY OUR CUSTOMER. NO RESPONSIBILITY IS UNDERTAKEN FOR ITS ACCURACY IN RELATION TO ORDERS PLACED FOR THE FITTING OF OUR GOODS WITHIN THE DIMENSIONS SHOWN.

**SCHEDULE &  
CUBIC CAPACITY****Symphony**<sup>®</sup>

Client Name: BLOOR HOMES

Site Name: FARINGDON, PARK ROAD,  
HAHouse Type: CLASSIC 3B5P SORLEY - EXC UTILITY  
RENTEDDrawing No: 527699\_\_  
Date Drawn: Thu, Nov 26, 2020  
Designed By:Revision No:  
Revision Date:

LUCY FLETCHER

Quote No:

## Items on Plan:

## Default Style

Plan No.	Qty	Code	Hdg	Description	Dims	CC (M3)
1	1	BR6623	L	Broom Unit	600/600/2276	0.63
2	1	BU56F	L	Base Unit FH	500/600/870	0.16
3	1	BU56F	L	Base Unit FH	500/600/870	0.16
4	1	CB126F	R	Corner Base FH (600 Door)	1200/600/870	0.41
5	1	DU66D		Drawer Unit	600/600/870	0.19
6	1	BU66F	L	Base Unit FH	600/600/870	0.20
7	1	BU66F	R	Base Unit FH	600/600/870	0.20
8	1	WU4590	L	Wall Unit	450/300/900	0.09
9	1	WU490	L	Wall Unit	400/300/900	0.08
10	1	WU4590	R	Wall Unit	450/300/900	0.09
11	1	WU690	R	Wall Unit	600/300/900	0.13
	1	BWU390C		Carcase Matched Wall Blender (For Filler)	307/970	

**Total cubic metres of storage****2.34**

## Worktop Details:

## Default Style

Plan No.	Qty	Code	Description	Dims
12	1	PF40	40mm P/F Worktop	1010/600
13	1	PF40	40mm P/F Worktop	800/600
14	1	PF40	40mm P/F Worktop	2600/600

## Accessories and Trims:

## Default Style

Qty	Code	Description	Dims
2	BRKPLINTH	Plinth Corner Bracket (Pack of 2)	
2	CONPLINTHC	Carcase Matched Continuous Plinth w/Plinth Seal	2600
1	ECOBIN4	Triple Ecobin	400
2	RUNITPROTECT	Kitchen Protective Material	
1	STRIPALP4010	Alum. P/F Strip (10)	40/665mm
3	STRIPALS4010	Alum. P/F End Cap (10)	40/650

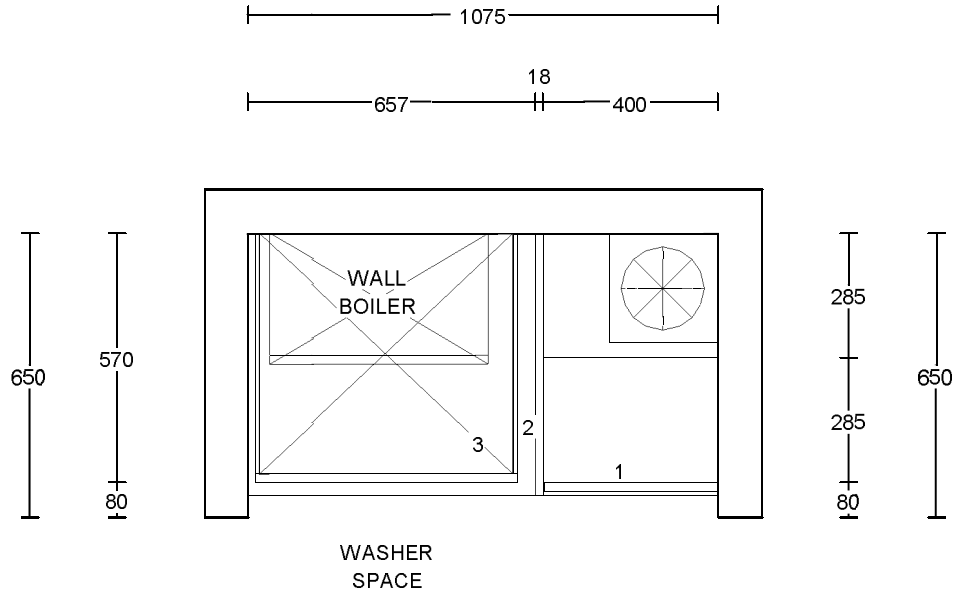

PLEASE CHECK ALL  
DIMENSIONS PRIOR TO  
ORDERING

Client:	BLOOR HOMES	Drawing No:	527699U_
Site:	FARINGDON, PARK ROAD, HA	Revision No:	
House Type:	CLASSIC 3B5P SORLEY - UTILITY	Scale:	Scale-to-fit
House Type 2:	RENTED		

**Symphony**<sup>®</sup>

**SCHEDULE &  
CUBIC CAPACITY**



Client Name: BLOOR HOMES

Site Name: FARINGDON, PARK ROAD,  
HA

House Type: CLASSIC 3B5P SORLEY - UTILITY  
RENTED

Drawing No: 527699U\_  
Date Drawn: Thu, Nov 26, 2020  
Designed By:

Revision No:  
Revision Date:

LUCY FLETCHER

Quote No:

Items on Plan:

Default Style

Plan No.	Qty	Code	Hdg	Description	Dims	CC (M3)
1	1	BU43F	R	Reduced Depth Base Unit FH	400/300/870	0.07
2	1	BBU6592C		Carcase Matched Base Blender	650/920	

**Total cubic metres of storage**

**0.07**

Worktop Details:

Default Style

Plan No.	Qty	Code	Description	Dims
3	1	PF40	40mm P/F Worktop	1200/600

Accessories and Trims:

Default Style

Qty	Code	Description	Dims
1	CONPLINTHC	Carcase Matched Continuous Plinth w/Plinth Seal	2600
1	RUNITPROTECT	Kitchen Protective Material	