

Client	BLOOR HOMES SWINDON/SOUTH WEST	Drawing No.	668187_C
Site	2018 CLASSIC RANGE SOCIAL BESPOKE/VARIATION	Revision No.	C
House Type	B30006 TILLYARD GF M4(2)	Scale	Scale-to-fit
House Type 2	2B4P		

THIS DRAWING IS THE PROPERTY OF THE SYMPHONY GROUP PLC. THE DRAWING IS ISSUED ON THE UNDERSTANDING THAT IT MUST NOT BE USED, COPIED OR CHANGED WITHOUT THE WRITTEN PERMISSION OF THE SYMPHONY GROUP PLC. ANY COMPONENTS OF APPLIANCES AND FITTINGS MUST NOT BE USED FOR ANY OTHER PURPOSE THAN FOR WHICH THE DRAWING IS ISSUED.

THIS PLAN IS OFFERED AS A GUIDE ONLY FOR APPROVAL BY OUR CUSTOMER. NO RESPONSIBILITY IS UNDERTAKEN FOR ITS ACCURACY. APPLICANT TO CHECK DIMENSIONS PRIOR TO ORDERING.

Symphony

**SCHEDULE &
CUBIC CAPACITY**



Client Name:	BLOOR HOMES SWINDON/SOUTH WEST	Site Name:	2018 CLASSIC RANGE SOCIAL BESPOKE/VARIATION
House Type:	B80006 TILLYARD GF M4(2) 2B4P		
Drawing No:	669187_C	Revision No:	C
Date Drawn:	Tue, Dec 13, 2022	Revision Date:	13.12.22
Designed By:	JAMIE NEEDHAM	Quote No:	

Items on Plan:

Plan No.	Qty	Code	Hdg	Description	Dims	CC (M3)
1	1	DU66D		Drawer Unit	600/600/870	0.19
2	1	CB106FB	L	Corner Base FH (400 Door)	1000/600/870	0.34
3	1	BU46F	L	Base Unit FH	400/600/870	0.13
4	1	BU56F	L	Base Unit FH	500/600/870	0.16
5	1	BU56F	R	Base Unit FH	500/600/870	0.16
6	1	BU456F	R	Base Unit FH	450/600/870	0.14
7	1	BR6623	R	Broom Unit	600/600/2276	0.63
8	1	TSP3X6P		Tray Space	300/600	0.03
9	1	BU36F	L	Base Unit FH	300/600/870	0.09
10	1	BU36F	L	Base Unit FH	300/600/870	0.09
11	1	WU4590	R	Wall Unit	450/300/900	0.09
12	1	WU390	R	Wall Unit	300/300/900	0.06
13	1	CWU690	L	Corner Wall (300 Door)	600/300/900	0.13
13.1	1	BBU6592C		Carcase Matched Base Blender **Use With CWU's if Required**	650/920	
14	1	WU690	L	Wall Unit	600/300/900	0.13
15	1	WU390	R	Wall Unit	300/300/900	0.06
16	1	WU690LK	R	Lockable Wall Unit	600/300/900	0.13
17	1	BH690	L	Boiler Housing	600/400/900	
	1	BSP390P		Base/Wall Unit Spacer Panel (For Filler)	300/900	

Total cubic metres of storage 2.56

Worktop Details:

Plan No.	Qty	Code	Description	Dims
18	1	PF40	40mm P/F Worktop	1300/600
19	1	PF40	40mm P/F Worktop	3000/600
20	1	PF40	40mm P/F Worktop	900/600

Accessories and Trims:

Qty	Code	Description	Dims
3	BRKPLINTH	Plinth Corner Bracket (Pack of 2)	

3	CONPLINTHC	Carcase Matched Continuous Plinth w/Plinth Seal	2800
1	ECOBIN4	Triple Ecobin 400 ** OLD CODE **	
2	RUNITPROTECT	Kitchen Protective Material	
2	STRIPALS4010	Alum. P/F End Cap (10)	40/650
2	WTOPPROTECT	Corrugated Worktop Protection	2400/1200

Accessories and Trims:

Default Style

Qty	Code	Description	Dims
1	STRIPALP4010	Alum. P/F Strip (10)	40/665mm

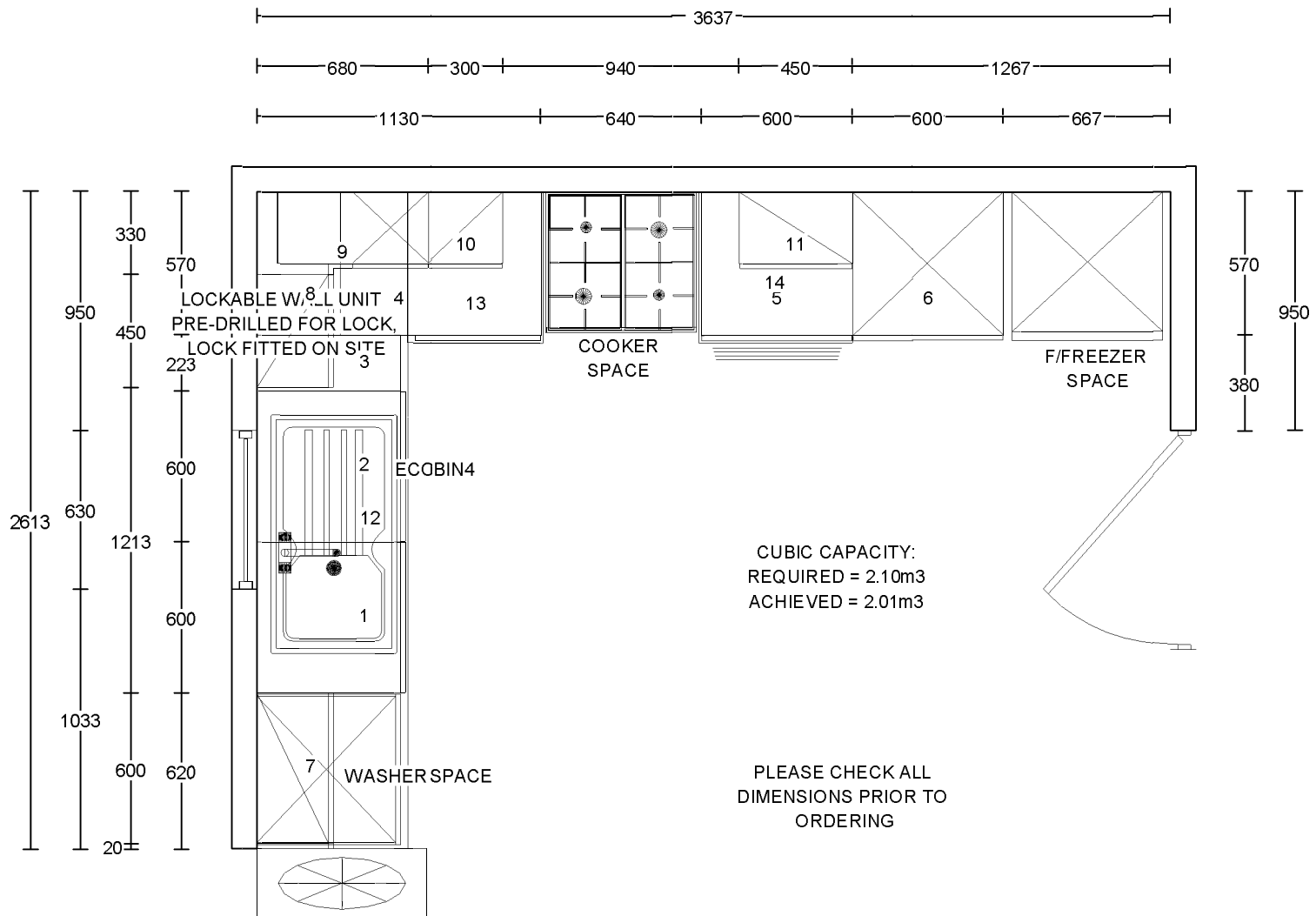

Client: BLOOR HOMES SWINDON/SOUTH WEST

Site: 2018 CLASSIC RANGE SOCIAL BESPOKE/VARIATION

House Type: B80006 TILLYARD FF

House Type 2: 2B4P

Drawing No: 669188_

Revision No:

Scale: Scale-to-fit

Symphony®

THIS DRAWING AND THE COPYRIGHT THEREIN IS THE PROPERTY OF THE SYMPHONY GROUP PLC. THIS DRAWING IS ISSUED ON THE CONDITION THAT IT MUST NOT BE USED, COPIED OR EXHIBITED WITHOUT THE WRITTEN PERMISSION OF THE SYMPHONY GROUP PLC. ANY COMPONENTS OR ARTICLES MADE IN ACCORDANCE WITH THIS DRAWING MUST NOT BE USED FOR ANY OTHER PURPOSE THAN FOR WHICH THE DRAWING IS ISSUED.

THIS PLAN IS OFFERED AS A GUIDE ONLY FOR APPROVAL BY OUR CUSTOMER. NO RESPONSIBILITY IS UNDERTAKEN FOR ITS ACCURACY IN RELATION TO ORDERS PLACED FOR THE FITTING OF OUR GOODS WITHIN THE DIMENSIONS SHOWN.

**SCHEDULE &
CUBIC CAPACITY**

Symphony®

Client Name:	BLOOR HOMES SWINDON/SOUTH WEST	Site Name:	2018 CLASSIC RANGE SOCIAL BESPOKE/VARIATION
House Type:	B80006 TILLYARD FF 2B4P		
Drawing No:	669188__	Revision No:	
Date Drawn:	Thu, Sep 22, 2022	Revision Date:	
Designed By:	SOMMER AL-KHAIAT	Quote No:	

Items on Plan: Default Style

Plan No.	Qty	Code	Hdg	Description	Dims	CC (M3)
1	1	BU66F	L	Base Unit FH	600/600/870	0.20
2	1	BU66F	R	Base Unit FH	600/600/870	0.20
3	1	TSP3X6P		Tray Space	300/600	0.03
4	1	CB86FCBO	L	Corner Base FH, No C/Post (500 Door)	800/600/870	0.26
5	1	DU66D		Drawer Unit	600/600/870	0.19
6	1	BR6623	R	Broom Unit	600/600/2276	0.63
7	1	WU690	L	Wall Unit	600/300/900	0.13
8	1	WU4590LK	R	Lockable Wall Unit	450/300/900	0.09
9	1	CWU690	L	Corner Wall (300 Door)	600/300/900	0.13
9.1	1	BBU6592C		Carcase Matched Base Blender **Use With CWU's if Required**	650/920	
10	1	WU390	L	Wall Unit	300/300/900	0.06
11	1	WU4590	R	Wall Unit	450/300/900	0.09
	1	BSP390P		Base/Wall Unit Spacer Panel (For Filler)	300/900	

Total cubic metres of storage 2.01

Worktop Details: Default Style

Plan No.	Qty	Code	Description	Dims
12	1	PF40	40mm P/F Worktop	2700/600
13	1	PF40	40mm P/F Worktop	600/600
14	1	PF40	40mm P/F Worktop	610/600

Accessories and Trims: Default Style

Qty	Code	Description	Dims
2	BRKPLINTH	Plinth Corner Bracket (Pack of 2)	
3	CONPLINTHC	Carcase Matched Continuous Plinth w/Plinth Seal	2800
1	ECOBIN4	Triple Ecobin 400 ** OLD CODE **	
2	RUNITPROTECT	Kitchen Protective Material	

1	STRIPALP4010	Alum. P/F Strip (10)	40/665
2	STRIPALS4010	Alum. P/F End Cap (10)	40/650
1	WTOPPROTECT	Corrugated Worktop Protection	2400/1200