

Client	BLOOR HOMES	Drawing No:	714967_D
Site:	2017 HOUSE TYPES	Revision No:	D
House Type:	353 - STANDARD	Scale:	Scale-to-fit
House Type 2:	EXC UTILITY		



THIS DRAWING AND THE COPYRIGHT THEREIN IS THE PROPERTY OF THE SYMPHONY GROUP PLC. THIS DRAWING IS ISSUED ON THE CONDITION THAT IT MUST NOT BE USED, COPIED OR EXHIBITED WITHOUT THE WRITTEN PERMISSION OF THE SYMPHONY GROUP PLC. ANY COMPONENTS OR ARTICLES MADE IN ACCORDANCE WITH THIS DRAWING MUST NOT BE USED FOR ANY OTHER PURPOSE THAN FOR WHICH THE DRAWING IS ISSUED.

THIS PLAN IS OFFERED AS A GUIDE ONLY FOR APPROVAL BY OUR CUSTOMER. NO RESPONSIBILITY IS UNDERTAKEN FOR ITS ACCURACY IN RELATION TO ORDERS PLACED FOR THE FITTING OF OUR GOODS WITHIN THE DIMENSIONS SHOWN.

**SCHEDULE &
CUBIC CAPACITY**

Symphony®

Client Name: BLOOR HOMES

Site Name: 2017 HOUSE TYPES
LEVEL 2

House Type: 353 - STANDARD
EXC UTILITY

Drawing No: 714967_D
Date Drawn: Thu, May 17, 2018
Designed By: LEIGH DURHAM

Revision No: D
Revision Date: 17.05.18

Quote No:

Items on Plan:

Default Style

Plan No.	Qty	Code	Hdg	Description	Dims	CC (M3)
1	1	BLU7523C		Carcase Matched Tall Blender	750/2400	
2	1	OH663A	L	Dbl Oven Hsg. (3A)	600/600/2100	0.28
3	1	SU66SLF	L	Sink Unit F/HT w/Sink Liner	600/600/870	0.19
4	1	BU86F		Base Unit FH	800/600/870	0.26
5	1	BU66F3IDC	L	Base Unit FH w/1x Shallow Int. Drw & 2x Deep Int. Drw	600/600/870	0.20
6	1	BU36F	R	Base Unit FH	300/600/870	0.09
7	1	LU66A	R	Larder Unit (Style A) (50/50 Split)	600/600/2100	0.52
8	1	BBU6592C		Carcase Matched Base Blender	650/920	
9	1	BU66F	L	Base Unit FH	600/600/870	0.20
10	1	BU66F	R	Base Unit FH	600/600/870	0.20
11	1	BU66F	R	Base Unit FH	600/600/870	0.20
12	1	WU672	L	Wall Unit	600/300/724	0.10
13	1	WU672	L	Wall Unit	600/300/724	0.10
14	1	WU872		Wall Unit	800/300/724	0.14
15	1	WU672	L	Wall Unit	600/300/724	0.10
16	1	WU372	R	Wall Unit	300/300/724	0.05
17	1	WU4572	L	Wall Unit	450/300/724	0.08
18	1	WU4572	R	Wall Unit	450/300/724	0.08
	1	CONPLINTH		Continuous Plinth (For Tall Filler)	2600	
	1	BSP372P		Base/Wall Unit Spacer Panel	300/724	
	1	BBU6592C		Carcase Matched Base Blender FOR BOXING IN PIPES	650/920	
	1	HOBSHIELD6		Hobshield	600	

Total cubic metres of storage

2.79

Worktop Details:

Default Style

Plan No.	Qty	Code	Description	Dims
19	1	PWT	40mm PVC Edged / 40mm Premium / 30mm Hi Def Worktop	3000/600
20	1	PWT	40mm PVC Edged / 40mm Premium / 30mm Hi Def Worktop	2000/600
	1	PFUP3095	Laminate Upstand	3050/95
	1	PFUP3095	Laminate Upstand	3050/95
	1	PFUP3095	Laminate Upstand	3050/95

Accessories and Trims:

Default Style

Qty	Code	Description	Dims
1	BRKPLINTH	Plinth Corner Bracket (Pack of 2)	

3	CONPLINTHC	Carcase Matched Continuous Plinth w/Plinth Seal	2600
1	CTRAYVFH6	Standard Internal Cutlery Tray (For BU66F3ID/BU66F4ID)	600
2	RUNITPROTECT	Kitchen Protective Material	
1	SBACK675	Stainless Steel Splashback	600/750
1	VENTGRILL200	Ventilation Grill - Flowrate	200cm2

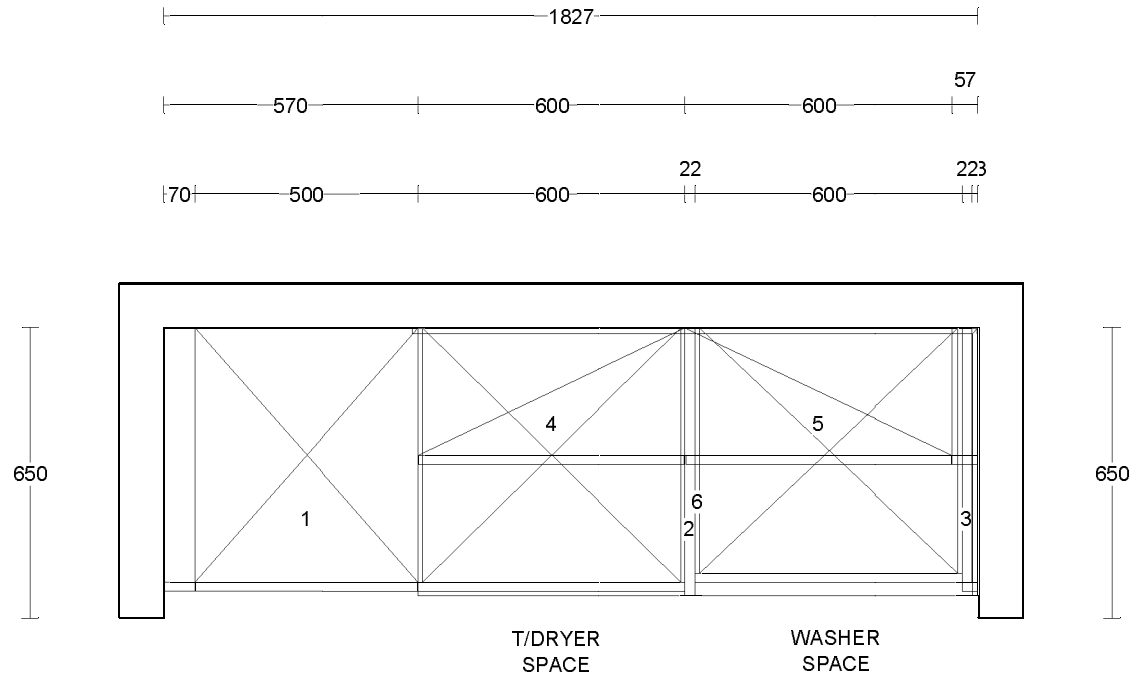

Client	BLOOR HOMES	Drawing No:	714967U_	Symphony®
Site:	2017 HOUSE TYPES	Revision No:		
House Type:	353 - STANDARD	Scale:	Scale-to-fit	
House Type 2:	UTILITY			

THIS DRAWING AND THE COPYRIGHT THEREIN IS THE PROPERTY OF THE SYMPHONY GROUP PLC. THIS DRAWING IS ISSUED ON THE CONDITION THAT IT MUST NOT BE USED, COPIED OR EXHIBITED WITHOUT THE WRITTEN PERMISSION OF THE SYMPHONY GROUP PLC. ANY COMPONENTS OR ARTICLES MADE IN ACCORDANCE WITH THIS DRAWING MUST NOT BE USED FOR ANY OTHER PURPOSE THAN FOR WHICH THE DRAWING IS ISSUED.

THIS PLAN IS OFFERED AS A GUIDE ONLY FOR APPROVAL BY OUR CUSTOMER. NO RESPONSIBILITY IS UNDERTAKEN FOR ITS ACCURACY IN RELATION TO ORDERS PLACED FOR THE FITTING OF OUR GOODS WITHIN THE DIMENSIONS SHOWN.

**SCHEDULE &
CUBIC CAPACITY**

Symphony®

Client Name: BLOOR HOMES

Site Name: 2017 HOUSE TYPES
LEVEL 2

House Type: 353 - STANDARD
UTILITY

Drawing No: 714967U_
Date Drawn: Thu, May 17, 2018
Designed By:

Revision No:
Revision Date:

TOM WATSON

Quote No:

Items on Plan:

Default Style

Plan No.	Qty	Code	Hdg	Description	Dims	CC (M3)
1	1	LU56	L	Larder Unit (70/30 Split)	500/600/2100	0.44
2	1	BBU6592C		Carcase Matched Base Blender	650/920	
3	1	BBU6592C		Carcase Matched Base Blender	650/920	
4	1	WU672	L	Wall Unit	600/300/724	0.10
5	1	WU672	R	Wall Unit	600/300/724	0.10
	1	CONPLINTH		Continuous Plinth (For Tall Filler)	2600	

Total cubic metres of storage

0.64

Worktop Details:

Default Style

Plan No.	Qty	Code	Description	Dims
6	1	PWT	40mm PVC Edged / 40mm Premium / 30mm Hi Def Worktop	1400/600
	1	PFUP3095	Laminate Upstand	3050/95

Accessories and Trims:

Default Style

Qty	Code	Description	Dims
1	BRKPLINTH	Plinth Corner Bracket (Pack of 2)	
1	BSP372P	Base/Wall Unit Spacer Panel (For Filler)	300/724
1	CONPLINTHC	Carcase Matched Continuous Plinth w/Plinth Seal	2600
1	RUNITPROTECT	Kitchen Protective Material	