

PLEASE ENSURE STRENGTH OF THE WALL & USE SCREWS AND RAWPLUGS SUITABLE FOR THE SPECIFIC WALL TYPE

2.2 CONTINUOUS RUN FOR SINK AND HOB REQUIRED  
400mm MIN RECOMMENDED EITHER SIDE OF HOB

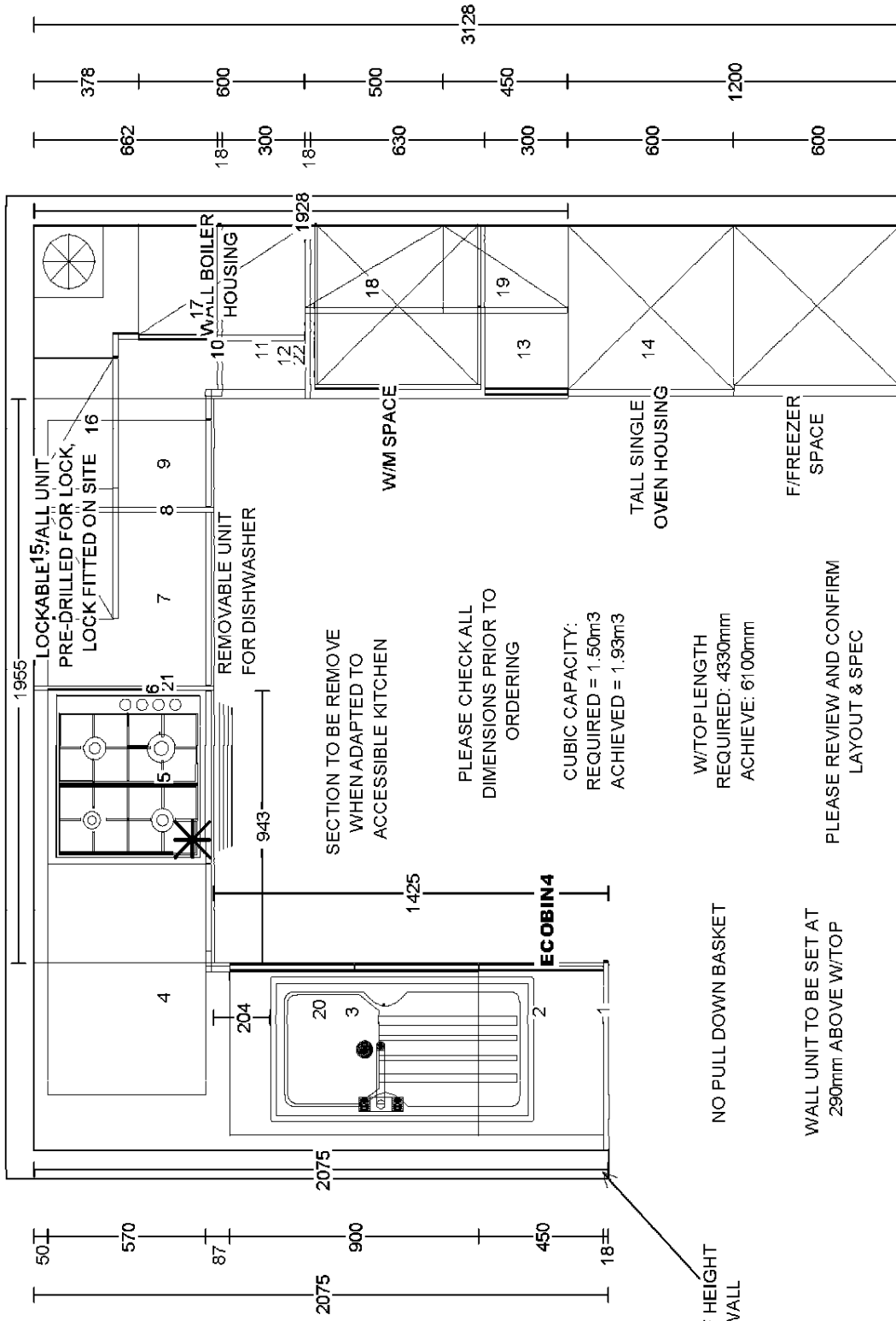

Client	BLOOR HOMES SWINDON/SOUTH WEST	Drawing No.	669183_C
Site	2018 CLASSIC RANGE SOCIAL BESPOKE/VARIATION	Revision No.	C
House Type	B80028 2 SAINTSBURY GF	Scale	Scale-to-fit
House Type 2	1B2P M4(3) ADAPTABLE		

THIS DRAWING IS THE PROPERTY OF THE SYMPHONY GROUP PLC. THE DRAWING IS ISSUED ON THE UNDERSTANDING THAT IT MUST NOT BE USED, COPIED OR CHANGED WITHOUT THE WRITTEN PERMISSION OF THE SYMPHONY GROUP PLC. ANY COMPONENTS OF SERVICES MADE IN ACCORDANCE WITH THIS DRAWING MUST NOT BE USED FOR ANY OTHER PURPOSE THAN THAT FOR WHICH IT IS ISSUED.

THIS PLAN IS OFFERED AS A GUIDE ONLY FOR APPROVAL BY OUR CUSTOMER. NO RESPONSIBILITY IS UNDERTAKEN FOR ANY ACCURACY, MERCHANTABILITY, ORDERS PLACED OR THE TERMS OF OUR GOODS BY MULTIPLE ORDERING SYSTEM.

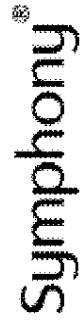

**SCHEDULE &  
CUBIC CAPACITY**



Client Name:	BLOOR HOMES SWINDON/SOUTH WEST	Site Name:	2018 CLASSIC RANGE SOCIAL BESPOKE/VARIATION
House Type:	B80028.2 SAINTSBURY GF 1B2P M4(3) ADAPTABLE		
Drawing No:	669183_C	Revision No:	C
Date Drawn:	Tue, Dec 13, 2022	Revision Date:	12.12.22
Designed By:	JAMIE NEEDHAM	Quote No:	

Items on Plan:

Plan No.	Qty	Code	Hdg	Description	Dims	CC (M3)
1	1	BBU6592C		Carcase Matched Base Blender	650/920	
2	1	BU456F	L	Base Unit FH	450/600/870	0.14
3	1	BU96F		Base Unit FH	900/600/870	0.29
4	1	CB86FBBO	L	Corner Base FH, No C/Post (300 Door)	800/600/870	0.26
5	1	DU66D		Drawer Unit	600/600/870	0.19
5.1	1	HOBSHIELD6		Hobshield	600	
6	1	BBU6592C		Carcase Matched Base Blender	650/920	
7	1	BU66F	R	Base Unit FH	600/600/870	0.20
8	1	BBU6592C		Carcase Matched Base Blender	650/920	
9	1	BU36F	R	Base Unit FH	300/600/870	0.09
10	1	BBU6592C		Carcase Matched Base Blender	650/920	
11	1	TSP3X6P		Tray Space	300/600	0.03
12	1	BBU6592C		Carcase Matched Base Blender	650/920	
13	1	BU36F	R	Base Unit FH	300/600/870	0.09
14	1	OH666A	R	Sgl Oven Hsg. (6A)	600/600/2100	0.28
15	1	WU4590LK	L	Lockable Wall Unit	450/300/900	0.09
16	1	WU4590	R	Wall Unit	450/300/900	0.09
17	1	BH690	L	Boiler Housing	600/400/900	
18	1	WU572	L	Wall Unit	500/300/724	0.08
19	1	WU4572	R	Wall Unit	450/300/724	0.08
	1	CPOSTPNL72		C/Post Matched Filler Panel (For C/Post)	720	
	1	CPOSTPNL72		C/Post Matched Filler Panel (For C/Post)	720	
<b>Total cubic metres of storage</b>						<b>1.91</b>

Worktop Details:

Plan No.	Qty	Code	Description	Dims
20	1	PF40	40mm P/F Worktop	2200/650

21	1	PF40	40mm P/F Worktop	2100/650
22	1	PF40	40mm P/F Worktop	2000/600

Accessories and Trims:

Default Style

Qty	Code	Description	Dims
1	BRKPLINTH	Plinth Corner Bracket (Pack of 2)	
3	CONPLINTHC	Carcase Matched Continuous Plinth w/Plinth Seal	2800
1	ECOBIN4	Triple Ecobin 400 ** OLD CODE **	
2	RUNITPROTECT	Kitchen Protective Material	
1	STRIPALS4010	Alum. P/F End Cap (10)	40/650
1	VENTGRIDGR	Aeration Grid Grey	510/45/15
1	WTEDG4	40mm Worktop Edging	3000
3	WTOPPROTECT	Corrugated Worktop Protection	2400/1200

Accessories and Trims:

Default Style

Qty	Code	Description	Dims
2	STRIPALP4010	Alum. P/F Strip (10)	40/665mm

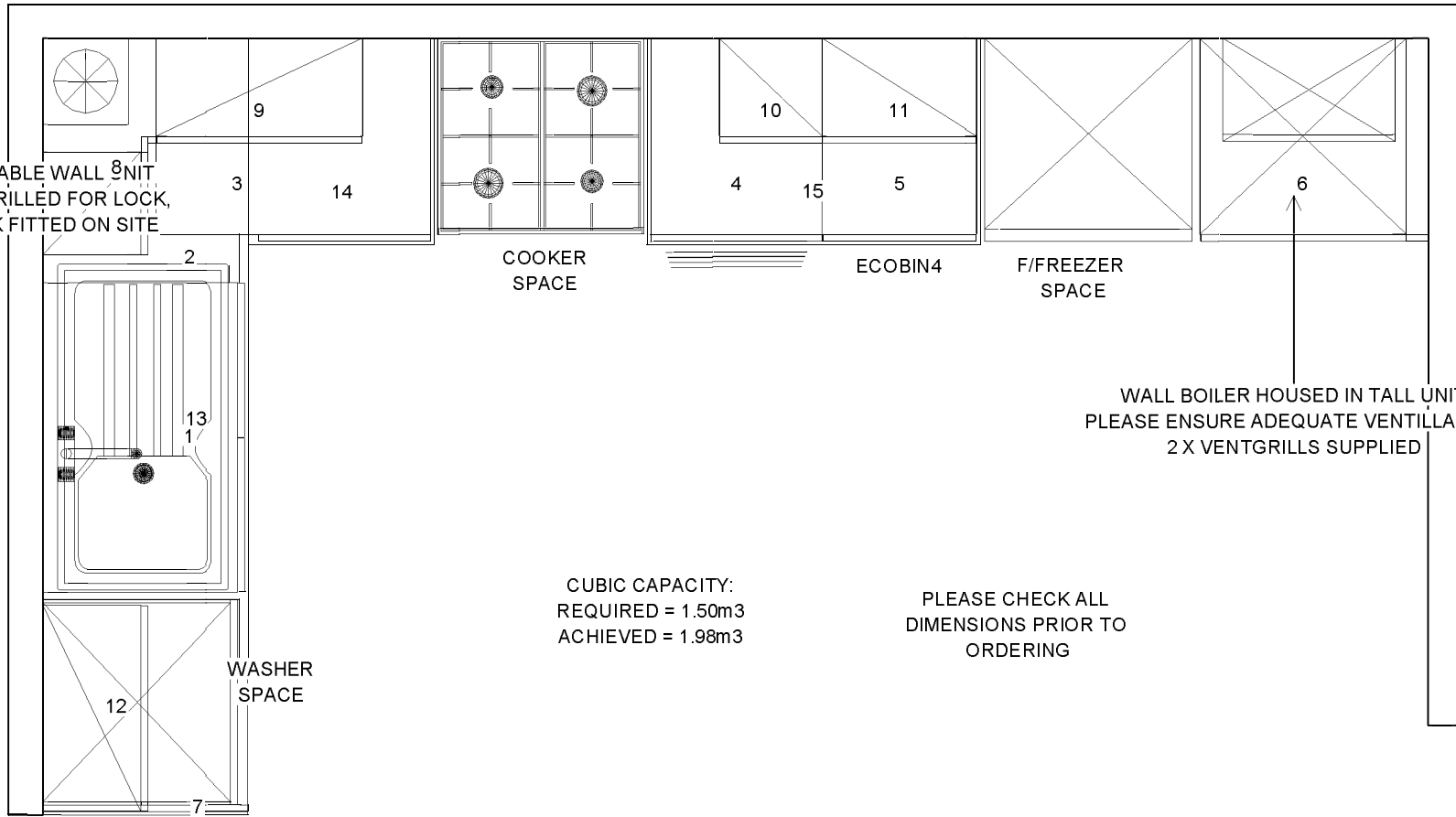
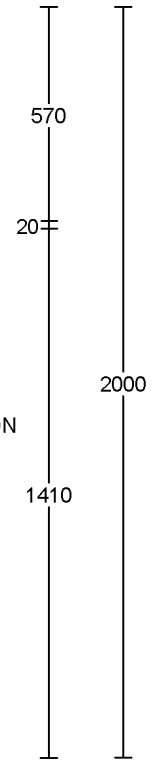
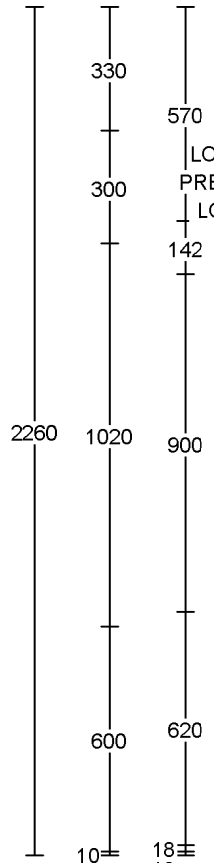
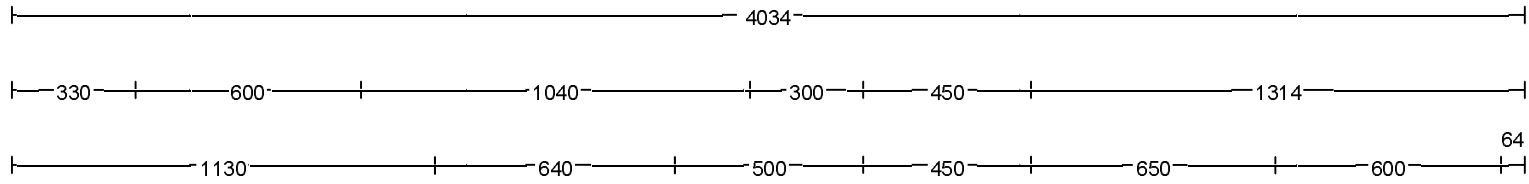

WALL BOILER HOUSED IN TALL UNIT  
PLEASE ENSURE ADEQUATE VENTILLATION  
2 X VENTGRILLS SUPPLIED

CUBIC CAPACITY:  
REQUIRED = 1.50m<sup>3</sup>  
ACHIEVED = 1.98m<sup>3</sup>

PLEASE CHECK ALL  
DIMENSIONS PRIOR TO  
ORDERING

Client:	BLOOR HOMES SWINDON/SOUTH WEST	Drawing No:	669184_A	<b>Symphony</b> <sup>®</sup>
Site:	2018 CLASSIC RANGE SOCIAL BESPOKE/VARIATION	Revision No:	A	
House Type:	B80028.2 SAINTSBURY FF	Scale:	Scale-to-fit	
House Type 2:	1B2P			
<small>THIS DRAWING AND THE COPYRIGHT THEREIN IS THE PROPERTY OF THE SYMPHONY GROUP PLC. THIS DRAWING IS ISSUED ON THE CONDITION THAT IT MUST NOT BE USED, COPIED OR EXHIBITED WITHOUT THE WRITTEN PERMISSION OF THE SYMPHONY GROUP PLC. ANY COMPONENTS OR ARTICLES MADE IN ACCORDANCE WITH THIS DRAWING MUST NOT BE USED FOR ANY OTHER PURPOSE THAN FOR WHICH THE DRAWING IS ISSUED.</small>		<small>THIS PLAN IS OFFERED AS A GUIDE ONLY FOR APPROVAL BY OUR CUSTOMER. NO RESPONSIBILITY IS UNDERTAKEN FOR ITS ACCURACY IN RELATION TO ORDERS PLACED FOR THE FITTING OF OUR GOODS WITHIN THE DIMENSIONS SHOWN.</small>		

**SCHEDULE &  
CUBIC CAPACITY**

**Symphony®**

Client Name:	BLOOR HOMES SWINDON/SOUTH WEST	Site Name:	2018 CLASSIC RANGE SOCIAL BESPOKE/VARIATION
House Type:	B80028.2 SAINTSBURY FF 1B2P		
Drawing No:	669184_A	Revision No:	A
Date Drawn:	Thu, Feb 23, 2023	Revision Date:	22.02.23
Designed By:	JOSHUA GOODISON	Quote No:	

Items on Plan: Default Style

Plan No.	Qty	Code	Hdg	Description	Dims	CC (M3)
1	1	BU96F		Base Unit FH	900/600/870	0.29
2	1	TSP3X6P		Tray Space	300/600	0.03
3	1	CB86FCBO	L	Corner Base FH, No C/Post (500 Door)	800/600/870	0.26
4	1	DU56D		Drawer Unit	500/600/870	0.16
5	1	BU456F	R	Base Unit FH	450/600/870	0.14
6	1	BR6623	R	Broom Unit	600/600/2276	0.63
7	1	BBU6592C		Carcase Matched Base Blender	650/920	
8	1	WU390LK	R	Lockable Wall Unit	300/300/900	0.06
9	1	WU690	L	Wall Unit	600/300/900	0.13
10	1	WU390	R	Wall Unit	300/300/900	0.06
11	1	WU4590	R	Wall Unit	450/300/900	0.09
12	1	WU690	L	Wall Unit	600/300/900	0.13
	1	CPOSTPNL90		C/Post Matched Filler Panel (For C/Post)	900	
	1	TINFILLC		Tall Infill Panel (Carcase Matched)	2600/142/15	

**Total cubic metres of storage 1.98**

Worktop Details: Default Style

Plan No.	Qty	Code	Description	Dims
13	1	PF40	40mm P/F Worktop	2400/600
14	1	PF40	40mm P/F Worktop	700/600
15	1	PF40	40mm P/F Worktop	970/600

Accessories and Trims: Default Style

Qty	Code	Description	Dims
3	BRKPLINTH	Plinth Corner Bracket (Pack of 2)	
3	CONPLINTHC	Carcase Matched Continuous Plinth w/Plinth Seal	2800
1	ECOBIN4	Triple Ecobin 400 ** OLD CODE **	

2	RUNITPROTECT	Kitchen Protective Material	
1	STRIPALP4010	Alum. P/F Strip (10)	40/665
4	STRIPALS4010	Alum. P/F End Cap (10)	40/650
2	VENTGRILL200	Ventilation Grill - Flowrate	200cm2
1	WTOPPROTECT	Corrugated Worktop Protection	2400/1200