

Client	BLOOR HOMES	Drawing No:	714960_B	Symphony®
Site:	2017 HOUSE TYPES	Revision No:	B	
House Type:	309 - STANDARD	Scale:	Scale-to-fit	
House Type 2:	EXC UTILITY			

THIS DRAWING AND THE COPYRIGHT THEREIN IS THE PROPERTY OF THE SYMPHONY GROUP PLC. THIS DRAWING IS ISSUED ON THE CONDITION THAT IT MUST NOT BE USED, COPIED OR EXHIBITED WITHOUT THE WRITTEN PERMISSION OF THE SYMPHONY GROUP PLC. ANY COMPONENTS OR ARTICLES MADE IN ACCORDANCE WITH THIS DRAWING MUST NOT BE USED FOR ANY OTHER PURPOSE THAN FOR WHICH THE DRAWING IS ISSUED.

THIS PLAN IS OFFERED AS A GUIDE ONLY FOR APPROVAL BY OUR CUSTOMER. NO RESPONSIBILITY IS UNDERTAKEN FOR ITS ACCURACY IN RELATION TO ORDERS PLACED FOR THE FITTING OF OUR GOODS WITHIN THE DIMENSIONS SHOWN.

**SCHEDULE &
CUBIC CAPACITY**

Symphony®

Client Name: BLOOR HOMES

Site Name: 2017 HOUSE TYPES
LEVEL 2

House Type: 309 - STANDARD
EXC UTILITY

Drawing No: 714960_B
Date Drawn: Thu, Oct 25, 2018
Designed By: LEIGH DURHAM

Revision No: B
Revision Date: 06.11.17

Quote No:

Items on Plan:

Default Style

Plan No.	Qty	Code	Hdg	Description	Dims	CC (M3)
1	1	BLU7523C		Carcase Matched Tall Blender	750/2400	
2	1	OH665A	R	Oven Housing (5A)	600/600/2100	0.28
3	1	BU46F	L	Base Unit F/HT	400/600/870	0.13
4	1	SU66SLF	L	Sink Unit F/HT w/Sink Liner	600/600/870	0.19
5	1	BBU6592C		Carcase Matched Base Blender	650/920	
6	1	CB106FCFP	L	Corner Base FH (600 Door) (Flexi C/Post)	1000/600/870	0.34
7	1	BU56F3IDC	L	Base Unit FH w/1x Shallow Int. Drw & 2x Deep Int. Drw	500/600/870	0.16
8	1	BU66F	L	Base Unit FH	600/600/870	0.20
9	1	BU56F	R	Base Unit FH	500/600/870	0.16
10	1	BU456F	R	Base Unit F/HT	450/600/870	0.14
11	1	WU472	L	Wall Unit	400/300/724	0.07
12	1	WU672	L	Wall Unit	600/300/724	0.10
13	1	WU672	R	Wall Unit	600/300/724	0.10
14	1	WU372	R	Wall Unit	300/300/724	0.05
15	1	WU372	L	Wall Unit	300/300/724	0.05
16	1	WU672	L	Wall Unit	600/300/724	0.10
17	1	WU4572	L	Wall Unit	450/300/724	0.08
18	1	WU4572	R	Wall Unit	450/300/724	0.08
19	1	WU4572	R	Wall Unit	450/300/724	0.08
	1	FRONTPNL72		Frontal Matched Filler Panel	720	
	1	BSP372P		Base/Wall Unit Spacer Panel	300/724	
	1	HOBSHIELD6		Hobshield	600	

Total cubic metres of storage

2.31

Worktop Details:

Default Style

Plan No.	Qty	Code	Description	Dims
20	1	PWT	40mm PVC Edged / 40mm Premium / 30mm Hi Def Worktop	2300/600
21	1	PWT	40mm PVC Edged / 40mm Premium / 30mm Hi Def Worktop	2900/600
	1	PFUP3095	Laminate Upstand 3050/95	3050/95
	1	PFUP3095	Laminate Upstand 3050/95	3050/95
	1	PFUP3095	Laminate Upstand	3050/95

Accessories and Trims:

Default Style

Qty	Code	Description	Dims
1	BRKPLINTH	Plinth Corner Bracket (Pack of 2)	

2	CONPLINTHC	Carcase Matched Continuous Plinth w/Plinth Seal	2600
1	CTRAYVFH5	Standard Internal Cutlery Tray (For BU56F3ID/BU56F4ID)	500
2	RUNITPROTECT	Kitchen Protective Material	
1	SBACK675	Stainless Steel Splashback	600/750
1	TOPSEALBOLT	Topseal Easibolt Pack	
1	VENTGRILL200	Ventilation Grill - Flowrate	200cm2

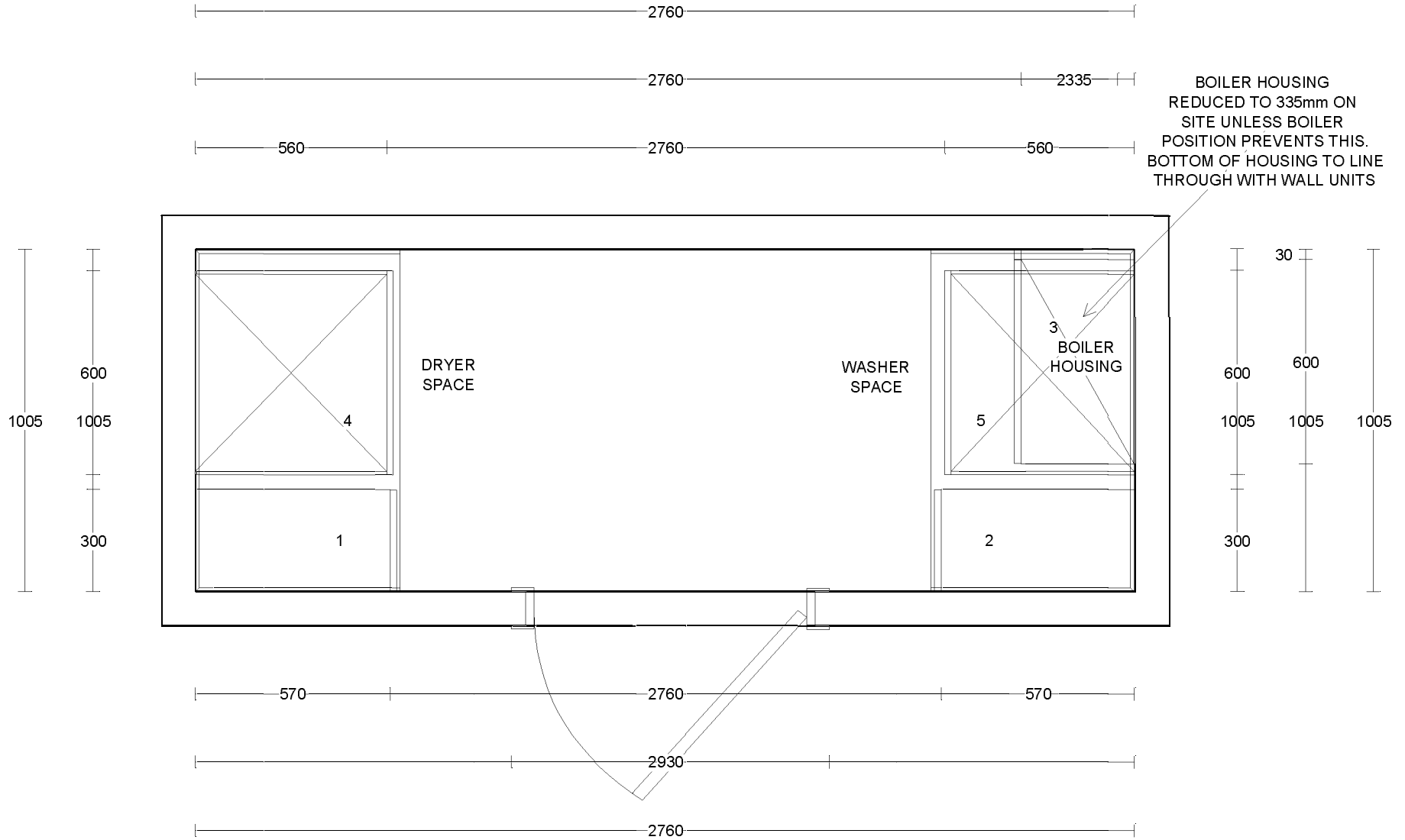

Client: BLOOR HOMES

Site: 2017 HOUSE TYPES

House Type: 309 - STANDARD

House Type 2: UTILITY

Drawing No: 714960UC

Revision No: C

Scale: Scale-to-fit

Symphony®

**SCHEDULE &
CUBIC CAPACITY**

Symphony®

Client Name:	BLOOR HOMES	Site Name:	2017 HOUSE TYPES LEVEL 2
House Type:	309 - STANDARD UTILITY		
Drawing No:	714960UC	Revision No:	C
Date Drawn:	Thu, Oct 25, 2018	Revision Date:	05.09.18
Designed By:	LEIGH DURHAM	Quote No:	

Items on Plan:

Default Style

Plan No.	Qty	Code	Hdg	Description	Dims	CC (M3)
1	1	BU36F	L	Base Unit F/HT	300/600/870	0.09
2	1	BU36F	R	Base Unit F/HT	300/600/870	0.09
3	1	BH690	L	Boiler Housing	600/400/900	
	1	BWU390C		Carcase Matched Wall Blender (For Filler)	307/970	
	1	BBU6592C		Carcase Matched Base Blender 650/920 **TO BOX BOILER PIPES**		
	1	BBU6592C		Carcase Matched Base Blender 650/920 **TO BOX BOILER PIPES**		

Total cubic metres of storage

0.18

Worktop Details:

Default Style

Plan No.	Qty	Code	Description	Dims
4	1	PWT	40mm PVC Edged / 40mm Premium / 30mm Hi Def Worktop	1100/600
5	1	PWT	40mm PVC Edged / 40mm Premium / 30mm Hi Def Worktop	1100/600
	1	PFUP3095	Laminate Upstand 3050/95	3050/95
	1	PFUP3095	Laminate Upstand 3050/95	3050/95

Accessories and Trims:

Default Style

Qty	Code	Description	Dims
1	BRKPLINTH	Plinth Corner Bracket (Pack of 2)	
1	CONPLINTHC	Carcase Matched Continuous Plinth w/Plinth Seal	2600
2	FITFACTOR	FITFACTOR	
1	RUNITPROTECT	Kitchen Protective Material	