

**SCHEDULE &
CUBIC CAPACITY**



Client Name:	BLOOR SWINDON (SOUTH WEST)	Site Name:	CHIPPENHAM PHASE 5 AFFORDABLE
House Type:	CLASSIC TOLKIEN M2BB3P RENTED		
Drawing No:	628087__	Revision No:	
Date Drawn:	Wed, Mar 16, 2022	Revision Date:	
Designed By:	SOMMER AL-KHAIAT	Quote No:	

Items on Plan:

Default Style

Plan No.	Qty	Code	Hdg	Description	Dims	CC (M3)
1	1	BR6623	L	Broom Unit	600/600/2276	0.63
2	1	BU66F	R	Base Unit FH	600/600/870	0.20
3	1	CB86FBBO	R	Corner Base FH, No C/Post (300 Door)	800/600/870	0.26
4	1	DU56D		Drawer Unit	500/600/870	0.16
5	1	CB86FABO	R	Corner Base FH, No C/Post (400 Door)	800/600/870	0.26
6	1	BBU6592C		Carcase Matched Base Blender	650/920	
7	1	BU66F	L	Base Unit FH	600/600/870	0.20
8	1	BU66F	R	Base Unit FH	600/600/870	0.20
9	1	TSP3X6P		Tray Space	300/600	0.03
10	1	BBU6592C		Carcase Matched Base Blender	650/920	
11	1	WU690	L	Wall Unit	600/300/900	0.13
12	1	WU690	R	Wall Unit	600/300/900	0.13
13	1	CWU690	L	Corner Wall (300 Door)	600/300/900	0.13
14	1	WU390	L	Wall Unit	300/300/900	0.06
15	1	WU390	R	Wall Unit	300/300/900	0.06
	1	CPOSTPNL72		C/Post Matched Filler Panel (For C/Post)	720	
	1	CPOSTPNL72		C/Post Matched Filler Panel (For C/Post)	720	

Total cubic metres of storage

2.45

Worktop Details:

Default Style

Plan No.	Qty	Code	Description	Dims
16	1	PF40	40mm P/F Worktop	1600/600
17	1	PF40	40mm P/F Worktop	700/600
18	1	PF40	40mm P/F Worktop	600/600
19	1	PF40	40mm P/F Worktop	2900/600

Accessories and Trims:

Default Style

--

Qty	Code	Description	Dims
2	BRKPLINTH	Plinth Corner Bracket (Pack of 2)	
3	CONPLINTHC	Carcase Matched Continuous Plinth w/Plinth Seal	2600
1	ECOBIN4	Triple Ecobin	400
2	RUNITPROTECT	Kitchen Protective Material	
2	STRIPALP4010	Alum. P/F Strip (10)	40/665mm
3	STRIPALS4010	Alum. P/F End Cap (10)	40/650

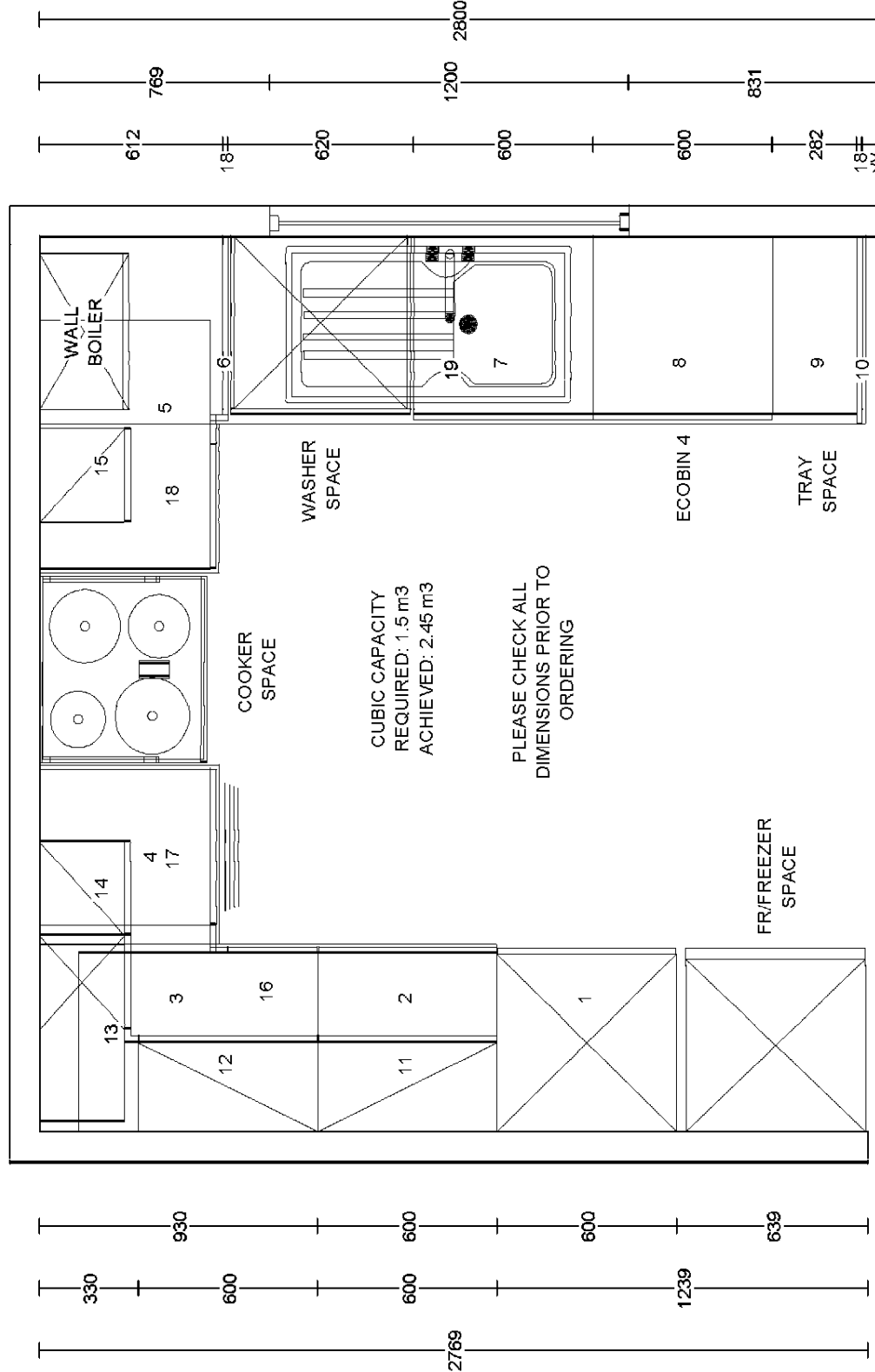
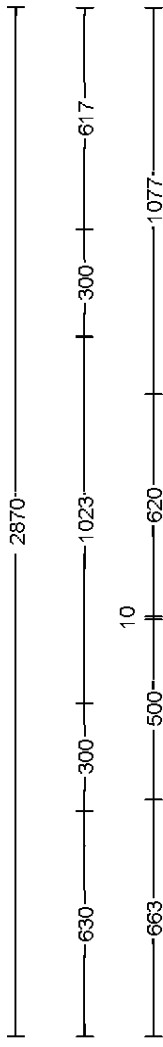

Client:	BLOOR SWINDON (SOUTH WEST)	Drawing No:	628087
Site:	CHIPPENHAM PHASE 5	Revision No:	
House Type:	CLASSIC TOLKIEN M2BB3P	Scale:	Scale-to-fit
House Type 2:	RENTED		

THIS DRAWING IS THE PROPERTY OF THE SYMPHONY GROUP PLC. THIS DRAWING IS ISSUED ON THE CONDITION THAT IT IS NOT TO BE USED, COPIED OR REPRODUCED WITHOUT THE WRITTEN PERMISSION OF THE SYMPHONY GROUP PLC. ANY COMPONENTS OR ARTICLES MADE IN ACCORDANCE WITH THIS DRAWING MUST NOT BE USED FOR ANY OTHER PURPOSE THAN FOR WHICH THE DRAWING IS ISSUED.

THIS PLAN IS OFFERED AS A GUIDE ONLY FOR APPROVAL BY OUR CUSTOMER. NO RESPONSIBILITY IS UNDERTAKEN FOR ITS ACCURACY IN RELATION TO ORDERS PLACED FOR THE FITTING OF OUR GOODS WITHIN THE DIMENSIONS SHOWN.

Symphony®

**SCHEDULE &
CUBIC CAPACITY****Symphony®**

Client Name:	BLOOR SWINDON (SOUTH WEST)	Site Name:	CHIPPENHAM PHASE 5 AFFORDABLE
House Type:	CLASSIC 2B4P SINCLAIR RENTED		
Drawing No:	628088__	Revision No:	
Date Drawn:	Wed, Mar 16, 2022	Revision Date:	
Designed By:	SOMMER AL-KHAIAT	Quote No:	

Items on Plan:

Default Style

Plan No.	Qty	Code	Hdg	Description	Dims	CC (M3)
1	1	BR6623	L	Broom Unit	600/600/2276	0.63
2	1	CB126FBO	R	Corner Base FH, No C/Post (600 Door)	1200/600/870	0.41
3	1	DU66D		Drawer Unit	600/600/870	0.19
4	1	CB126FBO	R	Corner Base FH, No C/Post (600 Door)	1200/600/870	0.41
5	1	BU66F	L	Base Unit FH	600/600/870	0.20
6	1	BBU6592C		Carcase Matched Base Blender	650/920	
7	1	WU690	L	Wall Unit	600/300/900	0.13
8	1	CWU690	R	Corner Wall, No C/Post (300 Door)	600/300/900	0.13
9	1	WU490	L	Wall Unit	400/300/900	0.08
10	1	WU490	L	Wall Unit	400/300/900	0.08
11	1	WU4590	R	Wall Unit	450/300/900	0.09
	1	CPOSTPNL72		C/Post Matched Filler Panel (For C/Post)	720	
	1	CPOSTPNL90		C/Post Matched Filler Panel (For C/Post)	900	
	1	CPOSTPNL72		C/Post Matched Filler Panel (For C/Post)	720	

Total cubic metres of storage**2.35**

Worktop Details:

Default Style

Plan No.	Qty	Code	Description	Dims
12	1	PF40	40mm P/F Worktop	1400/600
13	1	PF40	40mm P/F Worktop	800/600
14	1	PF40	40mm P/F Worktop	800/600
15	1	PF40	40mm P/F Worktop	2000/600

Accessories and Trims:

Default Style

Qty	Code	Description	Dims
-----	------	-------------	------

2	BRKPLINTH	Plinth Corner Bracket (Pack of 2)	
2	CONPLINTHC	Carcase Matched Continuous Plinth w/Plinth Seal	2600
1	ECOBIN4	Triple Ecobin	400
2	RUNITPROTECT	Kitchen Protective Material	
2	STRIPALP4010	Alum. P/F Strip (10)	40/665mm
3	STRIPALS4010	Alum. P/F End Cap (10)	40/650

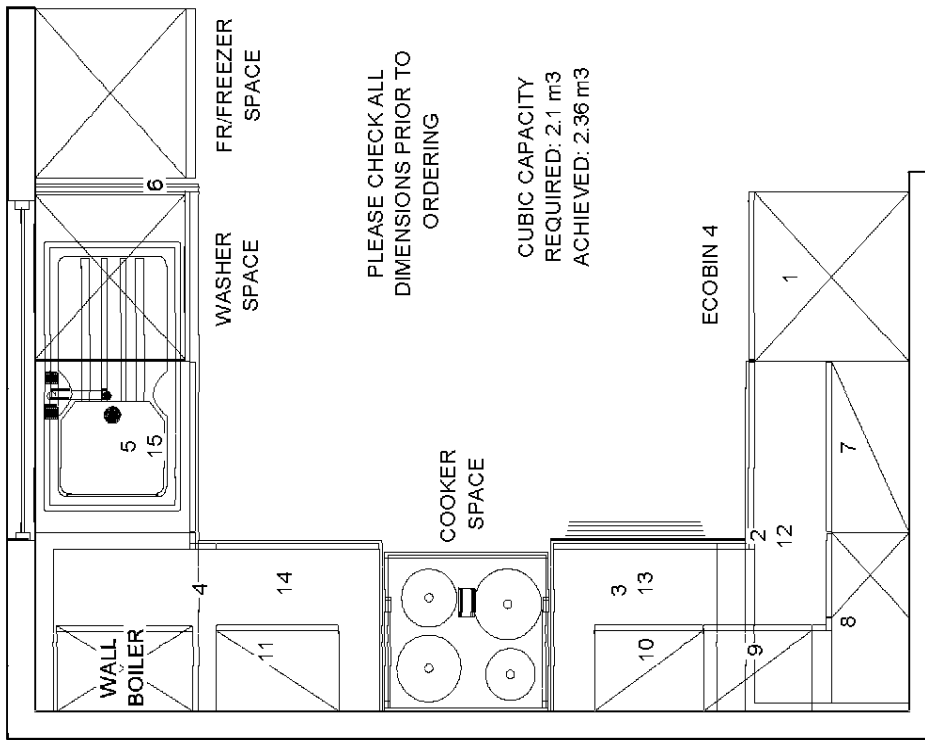
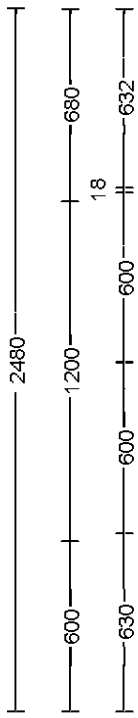

PLEASE CHECK ALL DIMENSIONS PRIOR TO ORDERING

CUBIC CAPACITY
REQUIRED: 2.1 m³
ACHIEVED: 2.36 m³

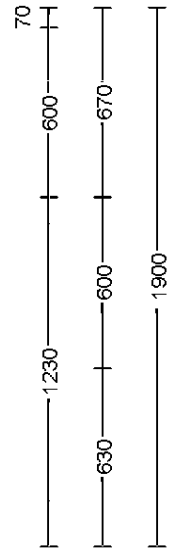
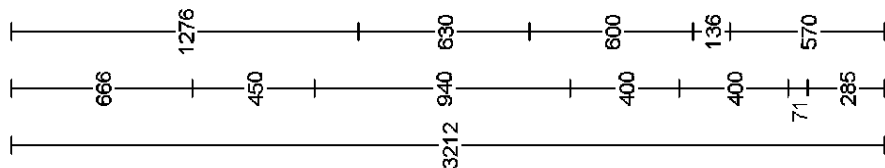

Client:	BLOOR SWINDON (SOUTH WEST)	Drawing No:	628088
Site:	CHIPPENHAM PHASE 5	Revision No:	
House Type:	CLASSIC 2B4P SNCLAIR	Scale:	Scale-to-fit
House Type 2:	RENTED		



THIS DRAWING AND THE COPYRIGHT THEREIN IS THE PROPERTY OF THE SYMPHONY GROUP PLC. THIS DRAWING IS ISSUED ON THE CONDITION THAT IT IS NOT TO BE REPRODUCED, COPIED OR EXHIBITED WITHOUT THE WRITTEN PERMISSION OF THE SYMPHONY GROUP PLC. ANY COMPONENTS OR APPLIANCES SHOWN IN THIS DRAWING MUST NOT BE USED TO PLAN OTHER PURCHASES UNLESS SPECIFICALLY STATED OTHERWISE. THIS DRAWING IS ISSUED AS A GUIDE ONLY FOR APPROVAL BY OUR CUSTOMER. NO RESPONSIBILITY IS UNDERTAKEN FOR ITS ACCURACY OR ITS SUITABILITY FOR RELIANTLY PLACED ORDERS FOR THE FITTING OF OUR GOODS WITHIN THE DIMENSIONS SHOWN.

**SCHEDULE &
CUBIC CAPACITY**



Client Name:	BLOOR SWINDON (SOUTH WEST)	Site Name:	CHIPPENHAM PHASE 5 AFFORDABLE
House Type:	CLASSIC 2B4P SINCLAIR SHARED		
Drawing No:	628089__	Revision No:	
Date Drawn:	Wed, Mar 16, 2022	Revision Date:	
Designed By:	SOMMER AL-KHAIAT	Quote No:	

Items on Plan:

Default Style

Plan No.	Qty	Code	Hdg	Description	Dims	CC (M3)
1	1	BR6623	L	Broom Unit	600/600/2276	0.63
2	1	CB126FBO	R	Corner Base FH, No C/Post (600 Door)	1200/600/870	0.41
3	1	DU66D		Drawer Unit	600/600/870	0.19
4	1	BOH66A		Built Under Housing	600/600/870	
5	1	CB126FBO	R	Corner Base FH, No C/Post (600 Door)	1200/600/870	0.41
6	1	BU66F	L	Base Unit FH	600/600/870	0.20
7	1	BBU6592C		Carcase Matched Base Blender	650/920	
8	1	WU690	L	Wall Unit	600/300/900	0.13
9	1	CWU690	R	Corner Wall, No C/Post (300 Door)	600/300/900	0.13
10	1	WU490	L	Wall Unit	400/300/900	0.08
11	1	WU490	L	Wall Unit	400/300/900	0.08
12	1	WU4590	R	Wall Unit	450/300/900	0.09
	1	CPOSTPNL72		C/Post Matched Filler Panel (For C/Post)	720	
	1	CPOSTPNL90		C/Post Matched Filler Panel (For C/Post)	900	
	1	CPOSTPNL72		C/Post Matched Filler Panel (For C/Post)	720	

Total cubic metres of storage

2.35

Worktop Details:

Default Style

Plan No.	Qty	Code	Description	Dims
13	1	PF40	40mm P/F Worktop	1400/600
14	1	PF40	40mm P/F Worktop	2100/600
15	1	PF40	40mm P/F Worktop	2000/600

Accessories and Trims:

Default Style

Qty	Code	Description	Dims

1	BRKPLINTH	Plinth Corner Bracket (Pack of 2)	
3	CONPLINTHC	Carcase Matched Continuous Plinth w/Plinth Seal	2600
1	ECOBIN4	Triple Ecobin	400
2	RUNITPROTECT	Kitchen Protective Material	
1	SBACK675	Stainless Steel Splashback	600/750
2	STRIPALP4010	Alum. P/F Strip (10)	40/665mm

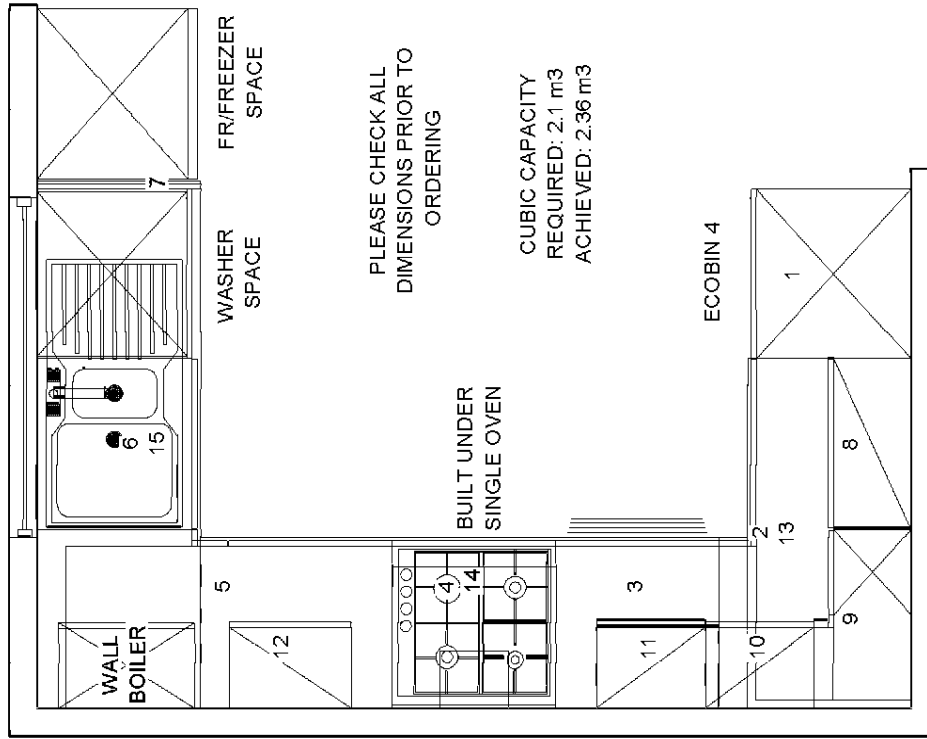
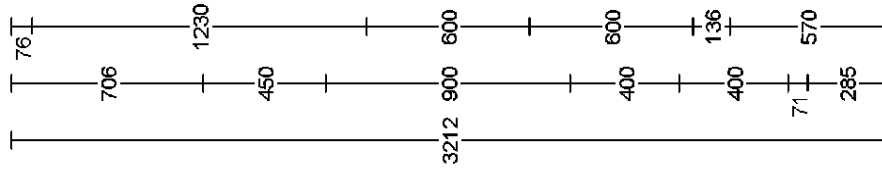
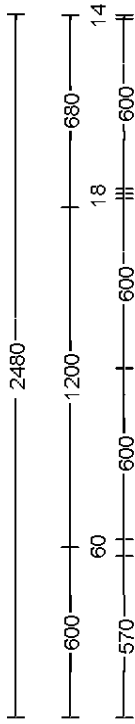

PLEASE CHECK ALL DIMENSIONS PRIOR TO ORDERING

CUBIC CAPACITY
REQUIRED: 2.1 m³
ACHIEVED: 2.36 m³

ECOBIN 4

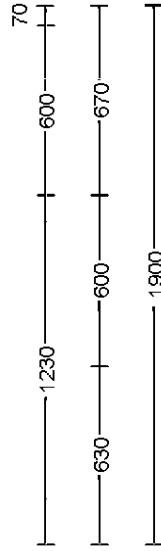

Client:	BLOOR SWINDON (SOUTH WEST)	Drawing No:	628088
Site:	CHIPPENHAM PHASE 5	Revision No:	
House Type:	CLASSIC 2B4P SNCLAIR	Scale:	Scale-to-fit
House Type 2:	SHARED		



THIS DRAWING AND THE COPYRIGHT IT BENE IS THE PROPERTY OF THE SYMPHONY GROUP PLC. THIS DRAWING IS ISSUED ON THE CONDITION THAT IT IS NOT TO BE REPRODUCED, COPIED OR EXHIBITED WITHOUT THE WRITTEN PERMISSION OF THE SYMPHONY GROUP PLC. ANY COMPONENTS OR PARTS MADE IN ACCORDANCE WITH THIS DRAWING MUST NOT BE USED FOR ANY OTHER PURPOSE THAN FOR WHICH THE DRAWING IS ISSUED. IN NO EVENT SHALL THE SYMPHONY GROUP BE RESPONSIBLE FOR ANY DAMAGE TO PROPERTY OR PERSONS OR FOR THE LOSS OF OR DAMAGE TO ANYTHING CAUSED BY THE USE OF THIS DRAWING.

**SCHEDULE &
CUBIC CAPACITY****Symphony®**

Client Name:	BLOOR SWINDON (SOUTH WEST)	Site Name:	CHIPPENHAM PHASE 5 AFFORDABLE
House Type:	CLASSIC 3B5P SORLEY - EXC UTILITY RENTED		
Drawing No:	628090__	Revision No:	
Date Drawn:	Wed, Mar 16, 2022	Revision Date:	
Designed By:	SOMMER AL-KHAIAT	Quote No:	

Items on Plan:

Default Style

Plan No.	Qty	Code	Hdg	Description	Dims	CC (M3)
1	1	BR6623	L	Broom Unit	600/600/2276	0.63
2	1	BU56F	L	Base Unit FH	500/600/870	0.16
3	1	BU56F	L	Base Unit FH	500/600/870	0.16
4	1	CB126F	R	Corner Base FH (600 Door)	1200/600/870	0.41
5	1	DU66D		Drawer Unit	600/600/870	0.19
6	1	BU66F	L	Base Unit FH	600/600/870	0.20
7	1	BU66F	R	Base Unit FH	600/600/870	0.20
8	1	WU4590	L	Wall Unit	450/300/900	0.09
9	1	WU490	L	Wall Unit	400/300/900	0.08
10	1	WU4590	R	Wall Unit	450/300/900	0.09
11	1	WU690	R	Wall Unit	600/300/900	0.13
	1	BWU390C		Carcase Matched Wall Blender (For Filler)	307/970	

Total cubic metres of storage**2.34**

Worktop Details:

Default Style

Plan No.	Qty	Code	Description	Dims
12	1	PF40	40mm P/F Worktop	1010/600
13	1	PF40	40mm P/F Worktop	800/600
14	1	PF40	40mm P/F Worktop	2600/600

Accessories and Trims:

Default Style

Qty	Code	Description	Dims
2	BRKPLINTH	Plinth Corner Bracket (Pack of 2)	
2	CONPLINTHC	Carcase Matched Continuous Plinth w/Plinth Seal	2600
1	ECOBIN4	Triple Ecobin	400
2	RUNITPROTECT	Kitchen Protective Material	
1	STRIPALP4010	Alum. P/F Strip (10)	40/665mm
3	STRIPALS4010	Alum. P/F End Cap (10)	40/650

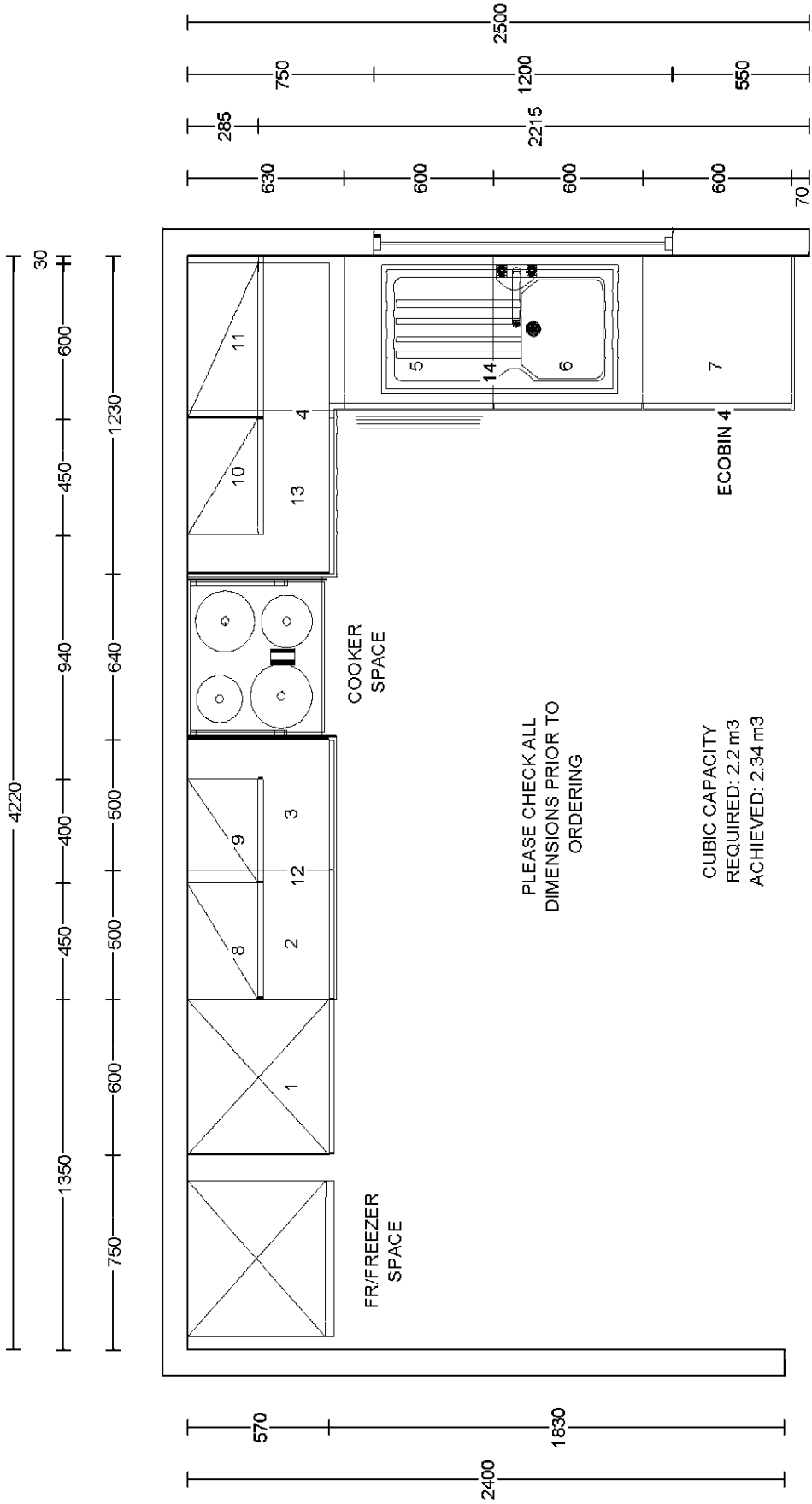

Client:	BLOOR SWINDON (SOUTH WEST)	Drawing No:	628080_
Site:	CHIPPENHAM PHASE 5	Revision No:	
House Type:	CLASSIC 3BSP SORLEY - EXC UTILITY	Scale:	Scale-to-fit
House Type 2:	RENTED		

THIS DRAWING IS THE PROPERTY OF THE SYMPHONY GROUP PLC. THIS DRAWING IS ISSUED ON THE CONDITION THAT IT IS NOT TO BE REPRODUCED, COPIED OR EXHIBITED WITHOUT THE WRITTEN PERMISSION OF THE SYMPHONY GROUP PLC. ANY COMPONENTS OR ARTICLES MADE IN ACCORDANCE WITH THIS DRAWING MUST NOT BE USED FOR ANY OTHER PURPOSE THAN FOR WHICH THE DRAWING IS ISSUED.

THIS PLAN IS OFFERED AS A GUIDE ONLY FOR APPROVAL BY OUR CUSTOMER. NO RESPONSIBILITY IS UNDERTAKEN FOR ITS ACCURACY IN RELATION TO ORDERS PLACED FOR THE FITTING OF OUR GOODS WITHIN THE DIMENSIONS SHOWN.

Symphony®

**SCHEDULE &
CUBIC CAPACITY**

Symphony®

Client Name:	BLOOR SWINDON (SOUTH WEST)	Site Name:	CHIPPENHAM PHASE 5 AFFORDABLE
House Type:	CLASSIC 3B5P SORLEY - UTILITY RENTED		
Drawing No:	628090U_	Revision No:	
Date Drawn:	Wed, Mar 16, 2022	Revision Date:	
Designed By:	SOMMER AL-KHAIAT	Quote No:	

Items on Plan:

Default Style

Plan No.	Qty	Code	Hdg	Description	Dims	CC (M3)
1	1	BU43F	R	Reduced Depth Base Unit FH	400/300/870	0.07
2	1	BBU6592C		Carcase Matched Base Blender	650/920	
Total cubic metres of storage						0.07

Worktop Details:

Default Style

Plan No.	Qty	Code	Description	Dims
3	1	PF40	40mm P/F Worktop	1200/600

Accessories and Trims:

Default Style

Qty	Code	Description	Dims
1	CONPLINTHC	Carcase Matched Continuous Plinth w/Plinth Seal	2600
1	RUNITPROTECT	Kitchen Protective Material	

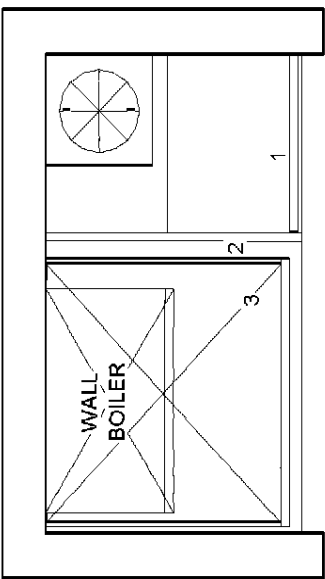
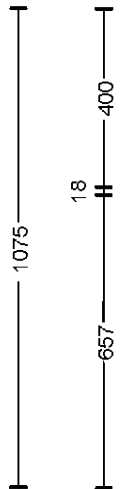

PLEASE CHECK ALL DIMENSIONS PRIOR TO ORDERING

Client:	BLOOR SWINDON (SOUTH WEST)	Drawing No:	628090U_
Site:	CHIPPENHAM PHASE 5	Revision No:	
House Type:	CLASSIC 3BSP SORLEY - UTILITY	Scale:	Scale-to-fit
House Type 2:	RENTED		
<small>THIS DRAWING AND THE COPYRIGHT THEREIN IS THE PROPERTY OF THE SYMPHONY GROUP PLC. THIS DRAWING IS ISSUED ON THE CONDITION THAT IT IS NOT TO BE USED, COPIED OR EXHIBITED WITHOUT THE WRITTEN PERMISSION OF THE SYMPHONY GROUP PLC. ANY COMPONENTS OR ARTICLES MADE IN ACCORDANCE WITH THIS DRAWING MUST NOT BE USED FOR ANY OTHER PURPOSE THAN FOR WHICH THE DRAWING IS ISSUED.</small>			
<small>THIS PLAN IS OFFERED AS A GUIDE ONLY FOR APPROXIMATE APPROVAL BY OUR CUSTOMER. THE RESPONSIBILITY IS UNDERTAKEN FOR ITS ACCURACY IN RELATION TO ANY ORDERS PLACED FOR THE FITTING OF OUR GOODS WITHIN THE DIMENSIONS SHOWN.</small>			
			Symphony [®]

**SCHEDULE &
CUBIC CAPACITY****Symphony®**

Client Name:	BLOOR SWINDON (SOUTH WEST)	Site Name:	CHIPPENHAM PHASE 5 AFFORDABLE
House Type:	CLASSIC 3B5P SORLEY - EXC UTILITY SHARED		
Drawing No:	628091__	Revision No:	
Date Drawn:	Wed, Mar 16, 2022	Revision Date:	
Designed By:	SOMMER AL-KHAIAT	Quote No:	

Items on Plan:		Default Style				
Plan No.	Qty	Code	Hdg	Description	Dims	CC (M3)
1	1	BR6623	L	Broom Unit	600/600/2276	0.63
2	1	BU56F	L	Base Unit FH	500/600/870	0.16
3	1	BU56F	L	Base Unit FH	500/600/870	0.16
4	1	BOH66A		Built Under Housing	600/600/870	
5	1	CB126F	R	Corner Base FH (600 Door)	1200/600/870	0.41
6	1	DU66D		Drawer Unit	600/600/870	0.19
7	1	BU66F	L	Base Unit FH	600/600/870	0.20
8	1	BU66F	R	Base Unit FH	600/600/870	0.20
9	1	WU4590	L	Wall Unit	450/300/900	0.09
10	1	WU490	L	Wall Unit	400/300/900	0.08
11	1	WU4590	R	Wall Unit	450/300/900	0.09
12	1	WU690	R	Wall Unit	600/300/900	0.13
	1	BWU390C		Carcase Matched Wall Blender (For Filler)	307/970	

Total cubic metres of storage**2.34**

Worktop Details:		Default Style		
Plan No.	Qty	Code	Description	Dims
13	1	PF40	40mm P/F Worktop	2400/600
14	1	PF40	40mm P/F Worktop	2600/600

Accessories and Trims:		Default Style		
Qty	Code	Description	Dims	
1	BRKPLINTH	Plinth Corner Bracket (Pack of 2)		
3	CONPLINTHC	Carcase Matched Continuous Plinth w/Plinth Seal	2600	
1	ECOBIN4	Triple Ecobin	400	
2	RUNITPROTECT	Kitchen Protective Material		
1	SBACK675	Stainless Steel Splashback	600/750	
1	STRIPALP4010	Alum. P/F Strip (10)	40/665mm	

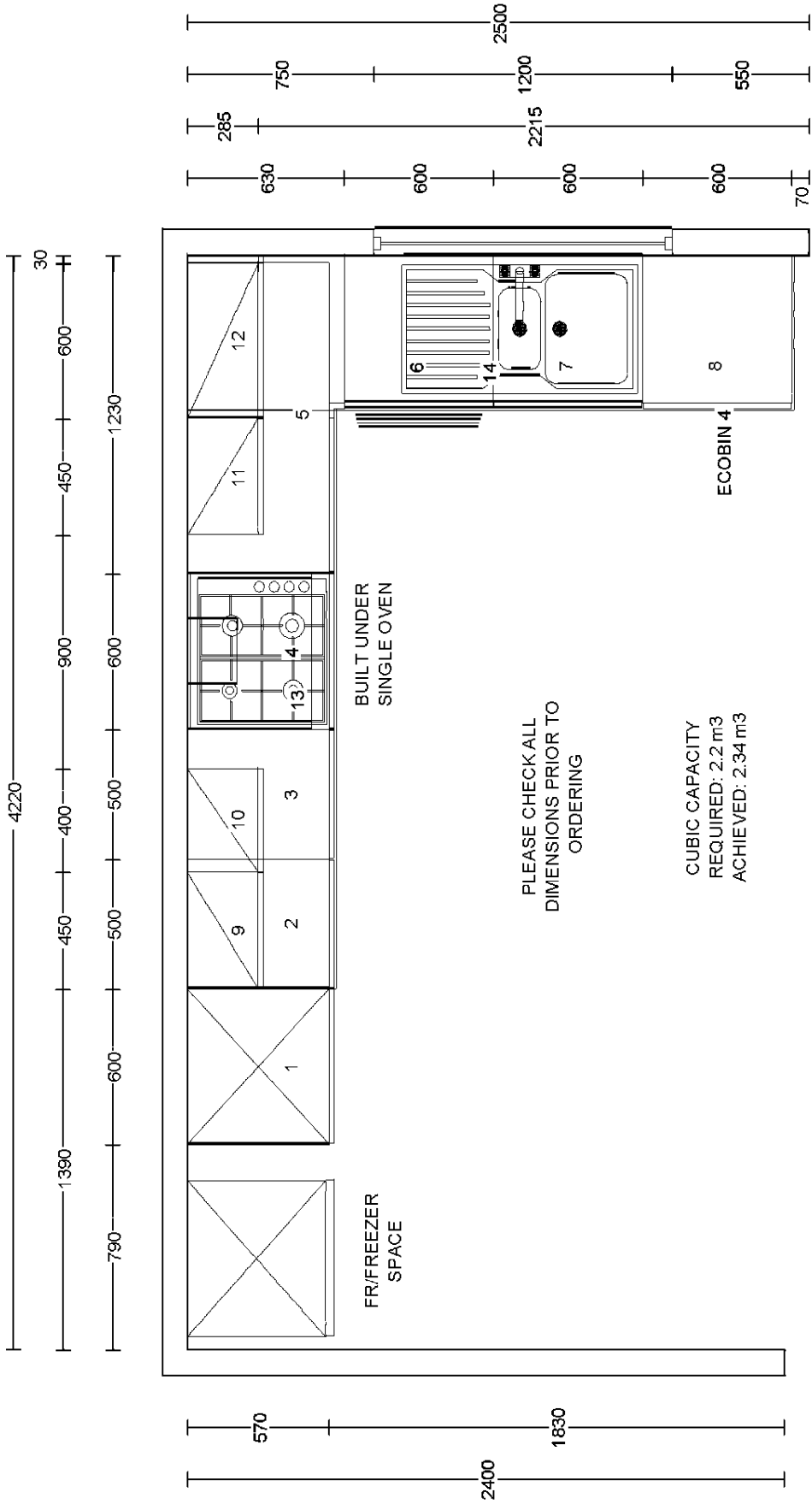

Client:	BLOOR SWINDON (SOUTH WEST)	Drawing No:	628081__
Site:	CHIPPENHAM PHASE 5	Revision No:	
House Type:	CLASSIC 3BSP SORLEY - EXC UTILITY	Scale:	Scale-to-fit
House Type 2:	SHARED		

THIS DRAWING AND THE COPYRIGHT THEREIN IS THE PROPERTY OF THE SYMPHONY GROUP PLC. THIS DRAWING IS ISSUED ON THE CONDITION THAT IT IS NOT TO BE REPRODUCED, COPIED OR EXHIBITED WITHOUT THE WRITTEN PERMISSION OF THE SYMPHONY GROUP PLC. ANY COMPONENTS OR ARTICLES MADE IN ACCORDANCE WITH THIS DRAWING MUST NOT BE USED FOR ANY OTHER PURPOSE THAN FOR WHICH THE DRAWING IS ISSUED.

THIS PLAN IS OFFERED AS A GUIDE ONLY FOR APPROVAL BY OUR CUSTOMER. NO RESPONSIBILITY IS UNDERTAKEN FOR ITS ACCURACY IN RELATION TO ORDERS PLACED FOR THE FITTING OF OUR GOODS WITHIN THE DIMENSIONS GIVEN.

Symphony®

**SCHEDULE &
CUBIC CAPACITY****Symphony®**

Client Name:	BLOOR SWINDON (SOUTH WEST)	Site Name:	CHIPPENHAM PHASE 5 AFFORDABLE
House Type:	CLASSIC 3B5P SORLEY - UTILITY SHARED		
Drawing No:	628091U_	Revision No:	
Date Drawn:	Wed, Mar 16, 2022	Revision Date:	
Designed By:	SOMMER AL-KHAIAT	Quote No:	

Items on Plan:

Default Style

Plan No.	Qty	Code	Hdg	Description	Dims	CC (M3)
1	1	BU43F	R	Reduced Depth Base Unit FH	400/300/870	0.07
2	1	BBU6592C		Carcase Matched Base Blender	650/920	
Total cubic metres of storage						0.07

Worktop Details:

Default Style

Plan No.	Qty	Code	Description	Dims
3	1	PF40	40mm P/F Worktop	1200/600

Accessories and Trims:

Default Style

Qty	Code	Description	Dims
1	CONPLINTHC	Carcase Matched Continuous Plinth w/Plinth Seal	2600
1	RUNITPROTECT	Kitchen Protective Material	

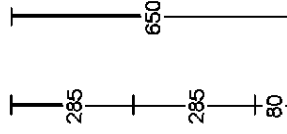
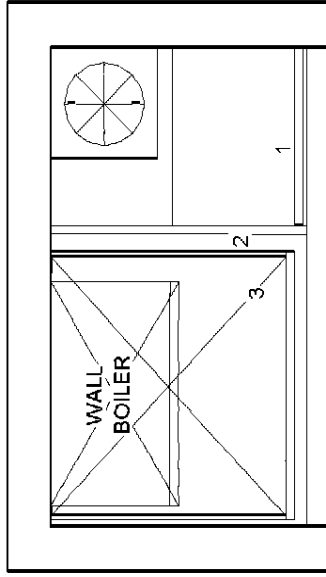
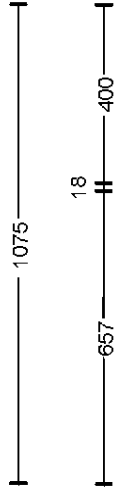

PLEASE CHECK ALL
DIMENSIONS PRIOR TO
ORDERING

Client:	BLOOR SWINDON (SOUTH WEST)	Drawing No:	628081U_
Site:	CHIPPENHAM PHASE 5	Revision No:	
House Type:	CLASSIC 3BSP SORLEY - UTILITY	Scale:	Scale-to-fit
House Type 2:	SHARED		
<small>THIS DRAWING AND THE COPYRIGHT THEREIN IS THE PROPERTY OF THE SYMPHONY GROUP PLC. THIS DRAWING IS ISSUED ON THE CONDITION THAT IT IS NOT TO BE USED, COPIED OR REPRODUCED WITHOUT THE WRITTEN PERMISSION OF THE SYMPHONY GROUP PLC. ANY COMPONENTS OR ARTICLES MADE IN ACCORDANCE WITH THIS DRAWING MUST NOT BE USED FOR ANY OTHER PURPOSE THAN FOR WHICH THE DRAWING IS ISSUED.</small>			
<small>THIS PLAN IS OFFERED AS A GUIDE ONLY FOR APPROVAL BY OUR CUSTOMER. RESPONSIBILITY IS UNDERTAKEN FOR ITS ACCURACY IN RELATION TO ORDERS PLACED FOR THE FITTING OF OUR GOODS WITHIN THE DIMENSIONS GIVEN.</small>			
			Symphony®

**SCHEDULE &
CUBIC CAPACITY**

Symphony[®]

Client Name:	BLOOR SWINDON (SOUTH WEST)	Site Name:	CHIPPENHAM PHASE 5 AFFORDABLE
House Type:	CLASSIC 4B6P STRAND - EXC UTILITY RENTED		
Drawing No:	628092__	Revision No:	
Date Drawn:	Wed, Mar 16, 2022	Revision Date:	
Designed By:	SOMMER AL-KHAIAT	Quote No:	

Items on Plan:

Default Style

Plan No.	Qty	Code	Hdg	Description	Dims	CC (M3)
1	1	BR6623	L	Broom Unit	600/600/2276	0.63
2	1	BU66F	L	Base Unit FH	600/600/870	0.20
3	1	DU66D		Drawer Unit	600/600/870	0.19
4	1	CB106FABO	R	Corner Base FH, No C/Post (500 Door)	1000/600/870	0.34
5	1	BU66F	L	Base Unit FH	600/600/870	0.20
6	1	BU66F	L	Base Unit FH	600/600/870	0.20
7	1	BU66F	R	Base Unit FH	600/600/870	0.20
8	1	BU46F	R	Base Unit FH	400/600/870	0.13
9	1	WU4590	L	Wall Unit	450/300/900	0.09
10	1	WU490	R	Wall Unit	400/300/900	0.08
11	1	WU690	R	Wall Unit	600/300/900	0.13
12	1	WU690	R	Wall Unit	600/300/900	0.13
	1	CPOSTPNL72		C/Post Matched Filler Panel (For C/Post)	720	
	1	BWU390C		Carcase Matched Wall Blender (For Filler)	307/970	

Total cubic metres of storage

2.52

Worktop Details:

Default Style

Plan No.	Qty	Code	Description	Dims
13	1	PF40	40mm P/F Worktop	610/600
14	1	PF40	40mm P/F Worktop	1300/600
15	1	PF40	40mm P/F Worktop	2900/600

Accessories and Trims:

Default Style

Qty	Code	Description	Dims
2	BRKPLINTH	Plinth Corner Bracket (Pack of 2)	
4	CONPLINTHC	Carcase Matched Continuous Plinth w/Plinth Seal	2600
1	ECOBIN4	Triple Ecobin	400
2	RUNITPROTECT	Kitchen Protective Material	

1	STRIPALP4010	Alum. P/F Strip (10)	40/665mm
3	STRIPALS4010	Alum. P/F End Cap (10)	40/650

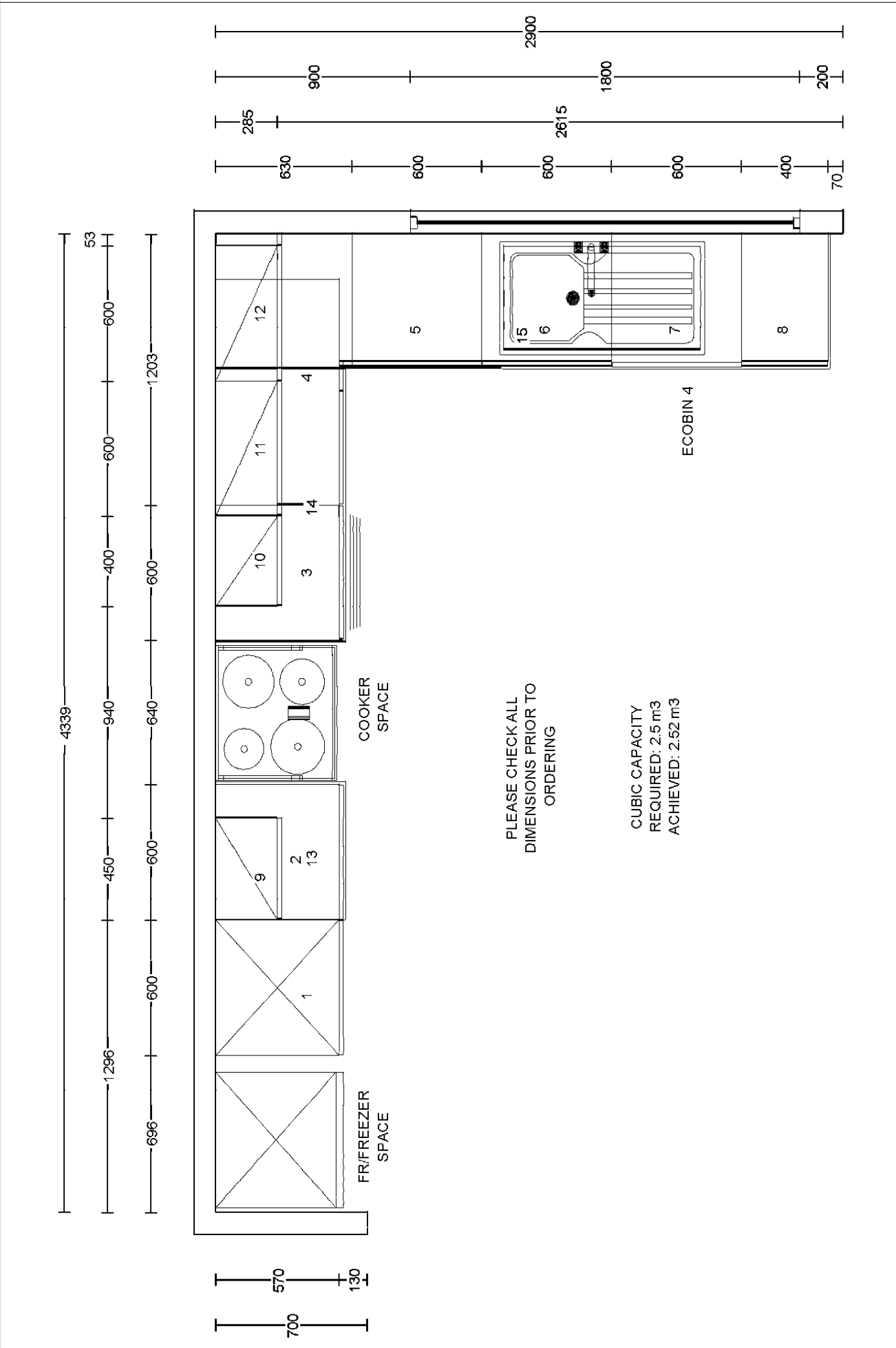

Client:	BLOOR SWINDON (SOUTH WEST)	Drawing No:	628082__
Site:	CHIPPENHAM PHASE 5	Revision No:	
House Type:	CLASSIC 4B&P STRAND - EXC UTILITY	Scale:	Scale-to-fit
House Type 2:	RENTED		

Symphony®

THIS DRAWING IS THE PROPERTY OF THE SYMPHONY GROUP PLC. THIS DRAWING IS ISSUED ON THE CONDITION THAT IT IS NOT TO BE USED, COPIED OR REPRODUCED WITHOUT THE WRITTEN PERMISSION OF THE SYMPHONY GROUP PLC. ANY COMPONENTS OR PARTS MADE IN ACCORDANCE WITH THIS DRAWING MUST NOT BE USED FOR ANY OTHER PURPOSE THAN FOR WHICH THE DRAWING IS ISSUED.

THIS PLAN IS OFFERED AS A GUIDE ONLY FOR APPROVAL BY OUR CUSTOMER. NO RESPONSIBILITY IS UNDERTAKEN FOR ITS ACCURACY IN RELATION TO ORDERS PLACED FOR THE FITTING OF OUR GOODS WITHIN THE DIMENSIONS SHOWN.

**SCHEDULE &
CUBIC CAPACITY****Symphony®**

Client Name:	BLOOR SWINDON (SOUTH WEST)	Site Name:	CHIPPENHAM PHASE 5 AFFORDABLE
House Type:	CLASSIC 4B6P STRAND - UTILITY RENTED		
Drawing No:	628092U_	Revision No:	
Date Drawn:	Wed, Mar 16, 2022	Revision Date:	
Designed By:	SOMMER AL-KHAIAT	Quote No:	

Items on Plan:

Default Style

Plan No.	Qty	Code	Hdg	Description	Dims	CC (M3)
2	1	BU456F	R	Base Unit FH	450/600/870	0.14
Total cubic metres of storage						0.14

Worktop Details:

Default Style

Plan No.	Qty	Code	Description	Dims
1	1	PF40	40mm P/F Worktop	1200/600

Accessories and Trims:

Default Style

Qty	Code	Description	Dims
1	BRKPLINTH	Plinth Corner Bracket (Pack of 2)	
1	CONPLINTHC	Carcase Matched Continuous Plinth w/Plinth Seal	2600
1	RUNITPROTECT	Kitchen Protective Material	

1075

625

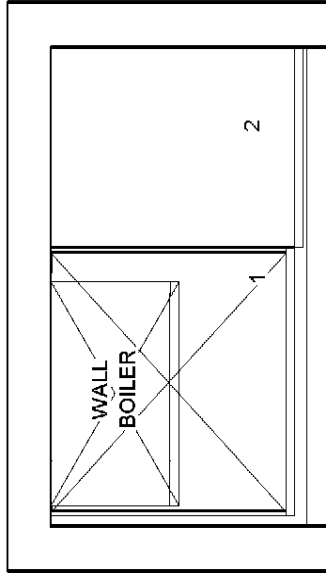

PLEASE CHECK ALL
DIMENSIONS PRIOR TO
ORDERING

Symphony®

Drawing No: 628082U_

Revision No:

Scale: Scale-to-fit

Client: BLOOR SWINDON (SOUTH WEST)

Site: CHIPPENHAM PHASE 5

House Type: CLASSIC 4B&P STRAND - UTILITY

House Type 2: RENTED

THIS DRAWING AND THE COPYRIGHT THEREIN IS THE PROPERTY OF THE SYMPHONY GROUP PLC. THIS DRAWING IS ISSUED ON THE CONDITION THAT IT IS NOT TO BE USED, COPIED OR REPRODUCED WITHOUT THE WRITTEN PERMISSION OF THE SYMPHONY GROUP PLC. ANY COMPONENTS OR PARTS MADE IN ACCORDANCE WITH THIS DRAWING MUST NOT BE USED TO REPAIR, ALTER OR IMPROVE THE DRAWING IS ISSUED. THIS PLAN IS OFFERED AS A GUIDE ONLY FOR APPROVAL BY OUR CUSTOMER. NO RESPONSIBILITY IS UNDERTAKEN FOR ITS ACCURACY IN RELATION TO CIRCUMSTANCES PLACED FOR THE FITTING OF OUR GOODS WITH THE DIMENSIONS GIVEN.

**SCHEDULE &
CUBIC CAPACITY**

Symphony®

Client Name:	BLOOR SWINDON (SOUTH WEST)	Site Name:	CHIPPENHAM PHASE 5 AFFORDABLE
House Type:	CLASSIC STORER RENTED		
Drawing No:	628093__	Revision No:	
Date Drawn:	Wed, Mar 16, 2022	Revision Date:	
Designed By:	SOMMER AL-KHAIAT	Quote No:	

Items on Plan:

Default Style

Plan No.	Qty	Code	Hdg	Description	Dims	CC (M3)
1	1	DU66D		Drawer Unit	600/600/870	0.19
2	1	CB96FABO	L	Corner Base FH, No C/Post (450 Door)	900/600/870	0.29
3	1	BU456F	R	Base Unit FH	450/600/870	0.14
4	1	CB106FBBO	L	Corner Base FH, No C/Post (400 Door)	1000/600/870	0.34
5	1	BU36F	R	Base Unit FH	300/600/870	0.09
6	1	BR6623	R	Broom Unit	600/600/2276	0.63
7	1	BU66F	L	Base Unit FH	600/600/870	0.20
8	1	BU66F	L	Base Unit FH	600/600/870	0.20
9	1	WU390	L	Wall Unit	300/300/900	0.06
10	1	WU690	R	Wall Unit	600/300/900	0.13
11	1	CWU690	L	Corner Wall (300 Door)	600/300/900	0.13
12	1	WU490	L	Wall Unit	400/300/900	0.08
13	1	WU390	R	Wall Unit	300/300/900	0.06
	1	CPOSTPNL72		C/Post Matched Filler Panel (For C/Post)	720	
	1	CPOSTPNL72		C/Post Matched Filler Panel (For C/Post)	720	

Total cubic metres of storage

2.54

Worktop Details:

Default Style

Plan No.	Qty	Code	Description	Dims
14	1	PF40	40mm P/F Worktop	600/600
15	1	PF40	40mm P/F Worktop	1400/600
16	1	PF40	40mm P/F Worktop	600/600
17	1	PF40	40mm P/F Worktop	2500/600

Accessories and Trims:

Default Style

Qty	Code	Description	Dims
2	BRKPLINTH	Plinth Corner Bracket (Pack of 2)	

3	CONPLINTHC	Carcase Matched Continuous Plinth w/Plinth Seal	2600
1	ECOBIN4	Triple Ecobin	400
2	RUNITPROTECT	Kitchen Protective Material	
2	STRIPALP4010	Alum. P/F Strip (10)	40/665mm
3	STRIPALS4010	Alum. P/F End Cap (10)	40/650

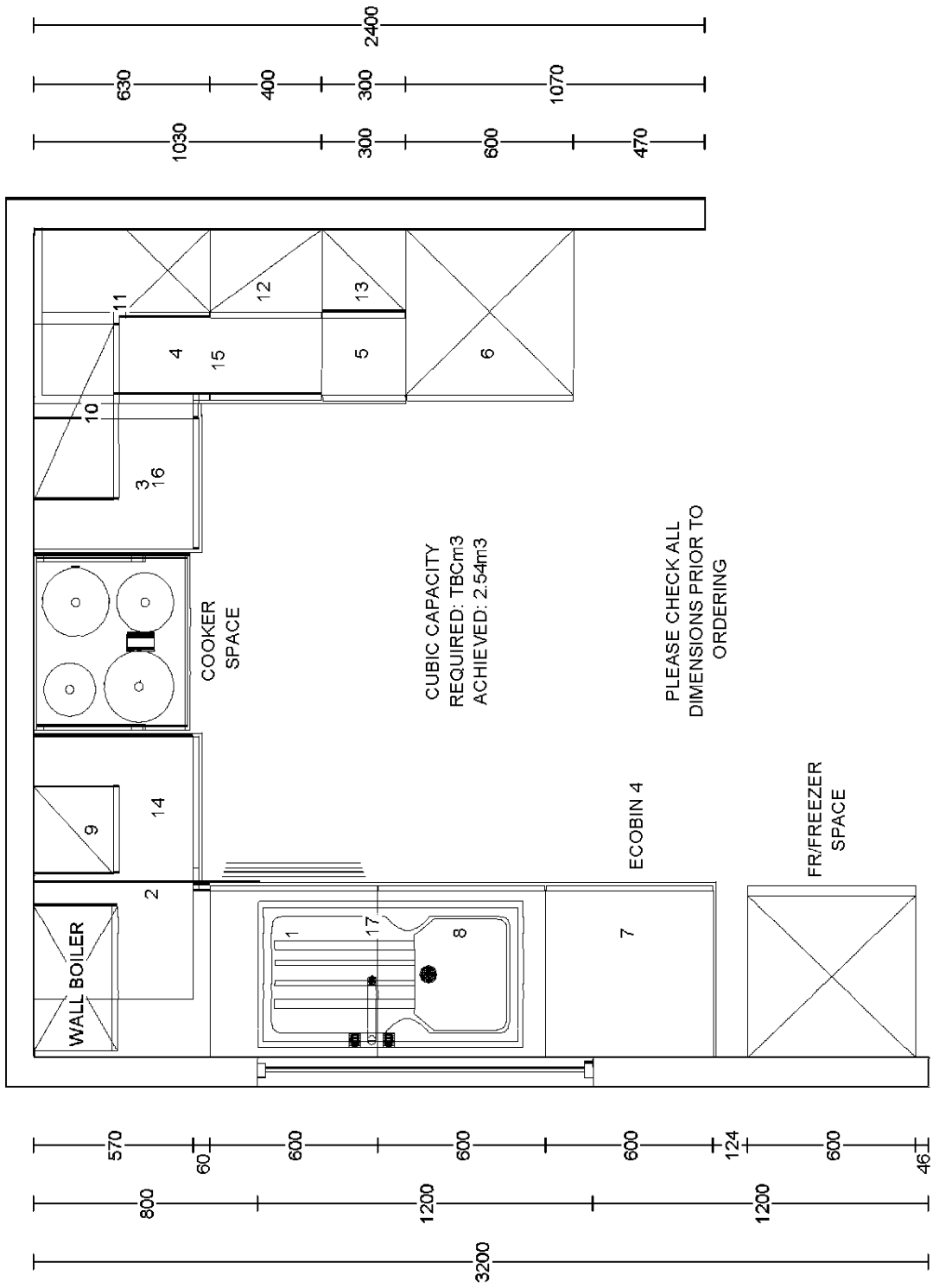
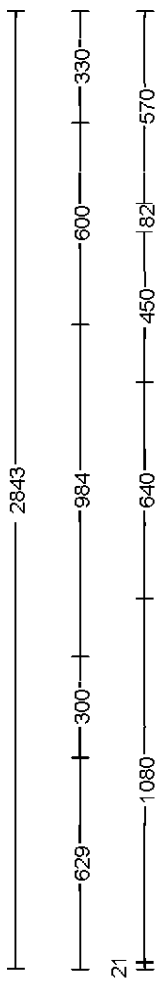

Client:	BLOOR SWINDON (SOUTH WEST)	Drawing No:	628093
Site:	CHIPPENHAM PHASE 5	Revision No:	
House Type:	CLASSIC STORER	Scale:	Scale-to-fit
House Type 2:	RENTED		

THIS DRAWING IS THE PROPERTY OF THE SYMPHONY GROUP PLC. THIS DRAWING IS ISSUED ON THE CONDITION THAT IT IS NOT TO BE REPRODUCED, COPIED OR EXHIBITED WITHOUT THE WRITTEN PERMISSION OF THE SYMPHONY GROUP PLC. ANY COMPONENTS OR PARTS MADE IN ACCORDANCE WITH THIS DRAWING MUST NOT BE USED FOR ANY OTHER PURPOSE THAN FOR WHICH THE DRAWING IS ISSUED.

THIS PLAN IS OFFERED AS A GUIDE ONLY FOR APPROVAL BY OUR CUSTOMER. NO RESPONSIBILITY IS UNDERTAKEN FOR ITS ACCURACY OR ITS SUITABILITY FOR THE FITTING OF OUR GOODS WITHIN THE DIMENSIONS SHOWN.

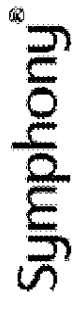

**SCHEDULE &
CUBIC CAPACITY**

Symphony®

Client Name:	BLOOR SWINDON (SOUTH WEST)	Site Name:	CHIPPENHAM PHASE 5 AFFORDABLE
House Type:	CLASSIC OAGSTONE 1B2P GF RENTED		
Drawing No:	613676__	Revision No:	
Date Drawn:	Thu, Mar 31, 2022	Revision Date:	
Designed By:	SOMMER AL-KHAIAT	Quote No:	

Items on Plan:

Default Style

Plan No.	Qty	Code	Hdg	Description	Dims	CC (M3)
1	1	BU46F	L	Base Unit FH	400/600/870	0.13
2	1	CB106FABO	R	Corner Base FH, No C/Post (500 Door)	1000/600/870	0.34
3	1	TSP3X6P		Tray Space	300/600	0.03
4	1	BU1506F	L	Base Unit FH	150/600/870	0.04
5	1	BU66F	L	Base Unit FH	600/600/870	0.20
6	1	BBU6592C		Carcase Matched Base Blender	650/920	
7	1	DU56D		Drawer Unit	500/600/870	0.16
8	1	CB86FB	L	Corner Base FH (300 Door)	800/600/870	0.26
9	1	BR6623	R	Broom Unit	600/600/2276	0.63
10	1	WU390LK	L	Lockable Wall Unit	300/300/900	0.06
11	1	WU490	L	Wall Unit	400/300/900	0.08
12	1	WU390	R	Wall Unit	300/300/900	0.06
13	1	CWU690	R	Corner Wall (300 Door)	600/300/900	0.13
13.1	1	BBU6592C		Carcase Matched Base Blender ***Use With CWU's if Required**	650/920	
14	1	WU690	L	Wall Unit	600/300/900	0.13

Total cubic metres of storage

2.25

Worktop Details:

Default Style

Plan No.	Qty	Code	Description	Dims
15	1	PF40	40mm P/F Worktop	2300/600
16	1	PF40	40mm P/F Worktop	1100/600
17	1	PF40	40mm P/F Worktop	600/600
18	1	PF40	40mm P/F Worktop	1000/600

Accessories and Trims:

Default Style

Qty	Code	Description	Dims
3	BRKPLINTH	Plinth Corner Bracket (Pack of 2)	

1	BSP372P	Base/Wall Unit Spacer Panel (For Filler)	300/724
3	CONPLINTHC	Carcase Matched Continuous Plinth w/Plinth Seal	2600
1	ECOBIN4	Triple Ecobin	400
2	RUNITPROTECT	Kitchen Protective Material	
2	STRIPALP4010	Alum. P/F Strip (10)	40/665mm
2	STRIPALS4010	Alum. P/F End Cap (10)	40/650

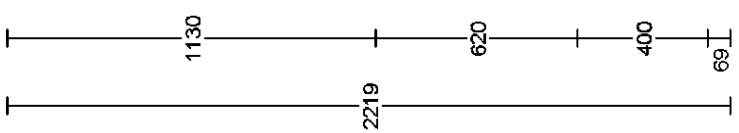
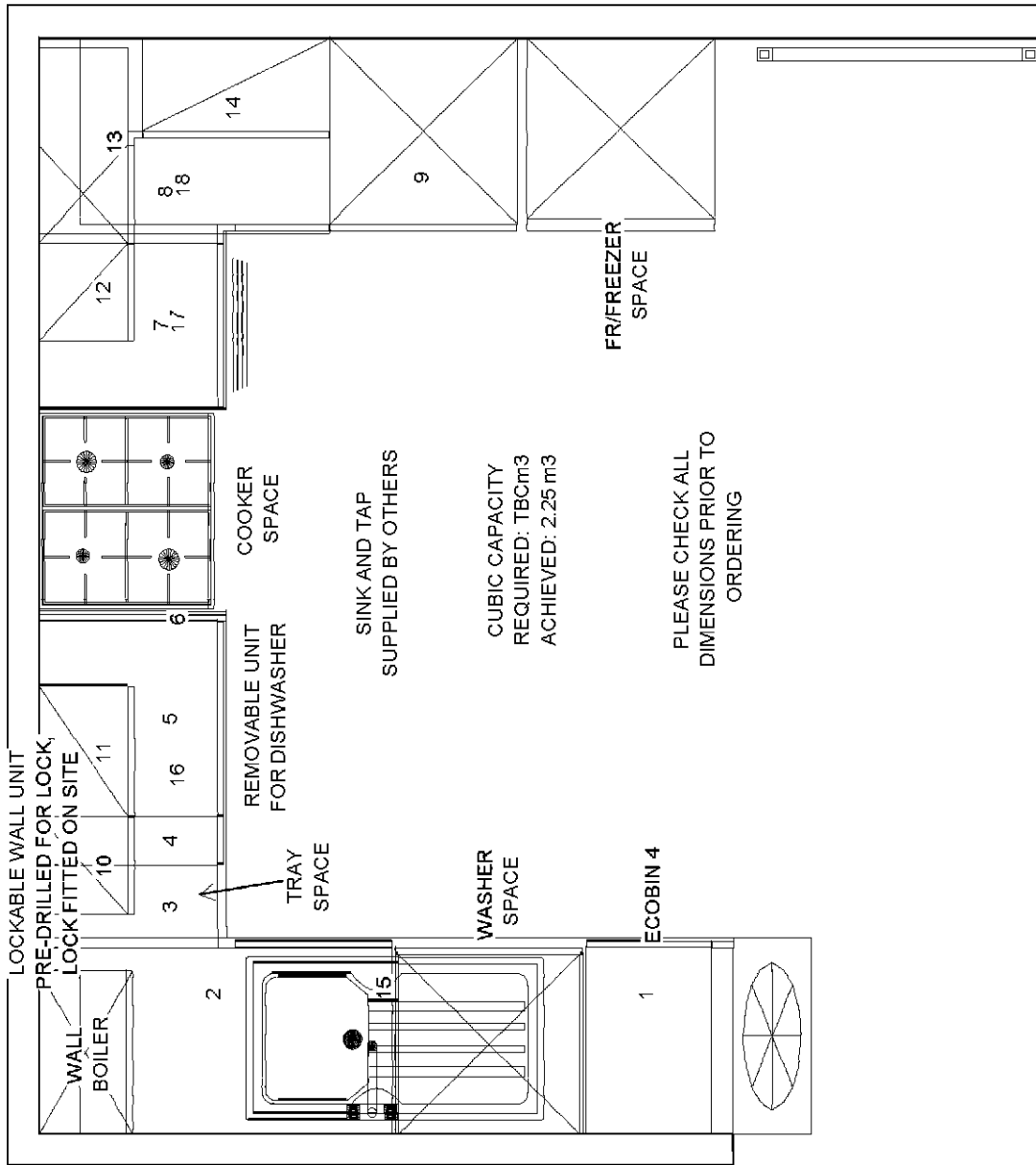
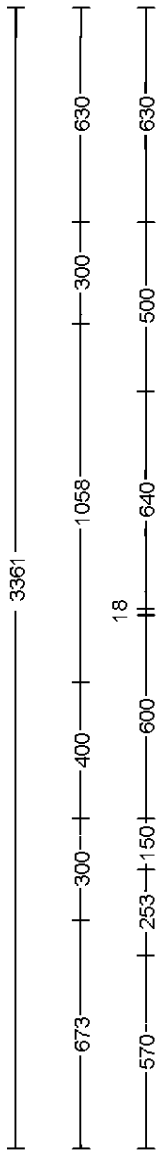

PLEASE CHECK ALL DIMENSIONS PRIOR TO ORDERING

CUBIC CAPACITY REQUIRED: 7.0m³ ACHIEVED: 2.25 m³

Client:	BLOOR SWINDON (SOUTH WEST)	Drawing No:	613676
Site:	CHIPPENHAM PHASE 5	Revision No:	
House Type:	CLASSIC OAGSTONE 1B2P GF	Scale:	Scale-to-fit
House Type 2:	RENTED		



THIS DRAWING AND THE COPYRIGHT THEREIN IS THE PROPERTY OF THE SYMPHONY GROUP PLC. THIS DRAWING IS ISSUED ON THE CONDITION THAT IT IS NOT TO BE USED, COPIED OR REPRODUCED WITHOUT THE WRITTEN PERMISSION OF THE SYMPHONY GROUP PLC. ANY COMPONENTS OR PARTS MADE IN ACCORDANCE WITH THIS DRAWING MUST NOT BE USED FOR ANY OTHER PURPOSE THAN FOR WHICH THE DRAWING IS ISSUED.

THIS PLAN IS OFFERED AS A GUIDE ONLY FOR APPROVAL BY OUR CUSTOMER. NO RESPONSIBILITY IS UNDERTAKEN FOR ITS ACCURACY IN RELATION TO ORDERS PLACED FOR THE FITTING OF OUR GOODS WITHIN THE DIMENSIONS SHOWN.

**SCHEDULE &
CUBIC CAPACITY**

Symphony®

Client Name:	BLOOR SWINDON (SOUTH WEST)	Site Name:	CHIPPENHAM PHASE 5 AFFORDABLE
House Type:	CLASSIC OAGSTONE 1B2P FF RENTED		
Drawing No:	613677__	Revision No:	
Date Drawn:	Thu, Mar 31, 2022	Revision Date:	
Designed By:	SOMMER AL-KHAIAT	Quote No:	

Items on Plan:

Default Style

Plan No.	Qty	Code	Hdg	Description	Dims	CC (M3)
1	1	BU46F	L	Base Unit FH	400/600/870	0.13
2	1	CB106FABO	R	Corner Base FH, No C/Post (500 Door)	1000/600/870	0.34
3	1	TSP3X6P		Tray Space	300/600	0.03
4	1	BU1506F	L	Base Unit FH	150/600/870	0.04
5	1	BU66F	L	Base Unit FH	600/600/870	0.20
6	1	BBU6592C		Carcase Matched Base Blender	650/920	
7	1	DU56D		Drawer Unit	500/600/870	0.16
8	1	CB86FB	L	Corner Base FH (300 Door)	800/600/870	0.26
9	1	BR6623	R	Broom Unit	600/600/2276	0.63
10	1	WU390LK	L	Lockable Wall Unit	300/300/900	0.06
11	1	WU490	L	Wall Unit	400/300/900	0.08
12	1	WU390	R	Wall Unit	300/300/900	0.06
13	1	CWU690	R	Corner Wall (300 Door)	600/300/900	0.13
13.1	1	BBU6592C		Carcase Matched Base Blender **Use With CWU's if Required**	650/920	
14	1	WU690	L	Wall Unit	600/300/900	0.13

Total cubic metres of storage

2.25

Worktop Details:

Default Style

Plan No.	Qty	Code	Description	Dims
15	1	PF40	40mm P/F Worktop	2300/600
16	1	PF40	40mm P/F Worktop	1100/600
17	1	PF40	40mm P/F Worktop	600/600
18	1	PF40	40mm P/F Worktop	1000/600

Accessories and Trims:

Default Style

Qty	Code	Description	Dims
3	BRKPLINTH	Plinth Corner Bracket (Pack of 2)	

1	BSP372P	Base/Wall Unit Spacer Panel (For Filler)	300/724
3	CONPLINTHC	Carcase Matched Continuous Plinth w/Plinth Seal	2600
1	ECOBIN4	Triple Ecobin	400
2	RUNITPROTECT	Kitchen Protective Material	
2	STRIPALP4010	Alum. P/F Strip (10)	40/665mm
2	STRIPALS4010	Alum. P/F End Cap (10)	40/650

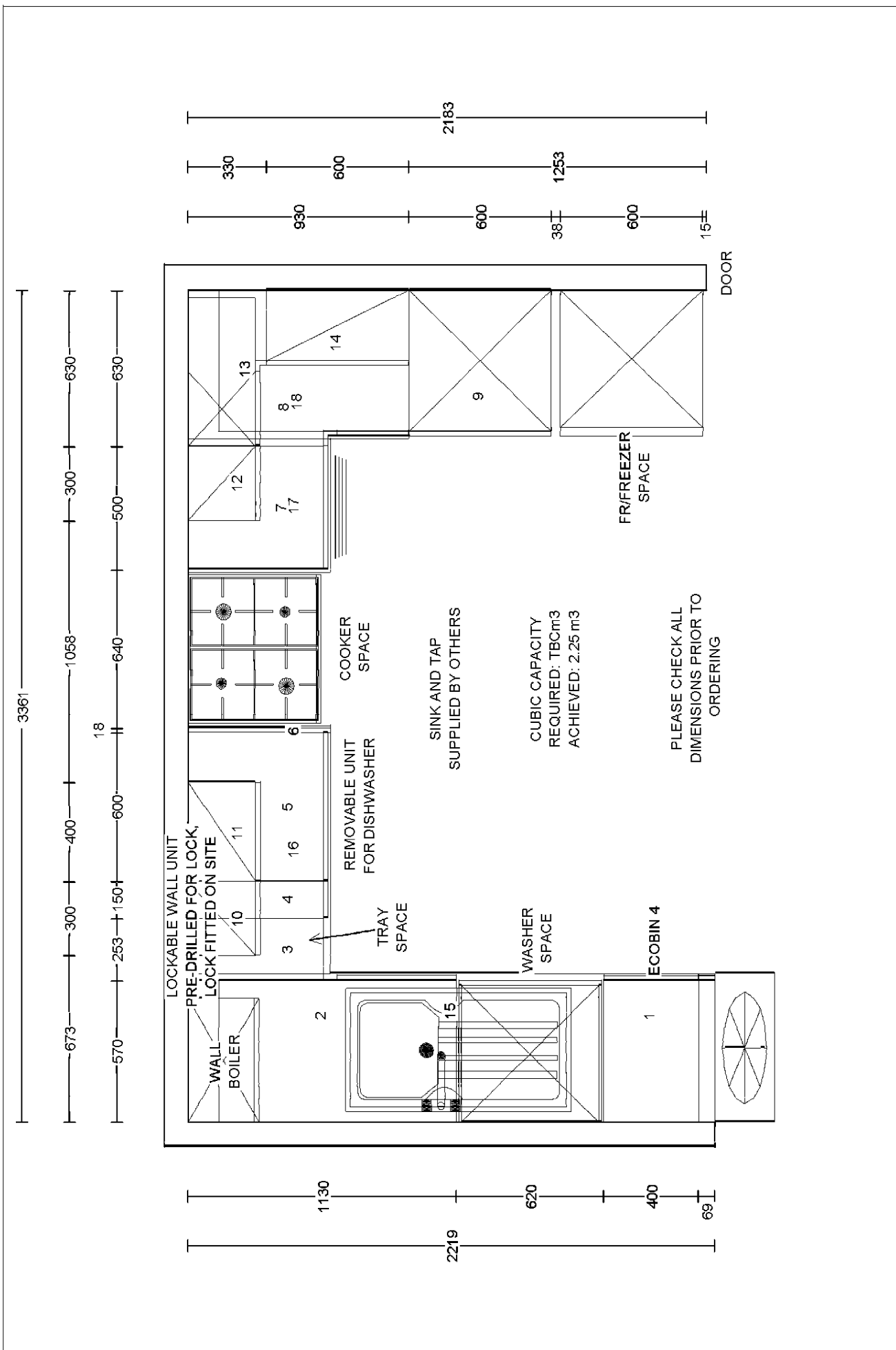

Client: BLOOR SWINDON (SOUTH WEST)		Drawing No: 613677
Site: CHIPPENHAM PHASE 5		Revision No:
House Type: CLASSIC OAGSTONE 1B2P FF		Scale: Scale-to-fit
House Type 2: RENTED		
<p>THIS DRAWING IS THE PROPERTY OF THE SUPPLIER GROUP PLC. THIS DRAWING IS ISSUED ON THE CONDITION THAT IT IS NOT TO BE REPRODUCED, COPIED OR EXHIBITED WITHOUT THE WRITTEN PERMISSION OF THE SUPPLIER GROUP PLC. ANY COMPONENTS OR PARTS MADE IN ACCORDANCE WITH THIS DRAWING MUST NOT BE USED FOR ANY OTHER PURPOSE THAN FOR WHICH THE DRAWING IS ISSUED.</p> <p>THIS PLAN IS OFFERED AS A GUIDE ONLY FOR APPROVAL BY OUR CUSTOMER. NO RESPONSIBILITY IS UNDERTAKEN FOR ITS ACCURACY IN RELATION TO FITTING OF OUR GOODS WITH THE DIMENSIONS SHOWN.</p>		



**SCHEDULE &
CUBIC CAPACITY**



Client Name:	BLOOR SWINDON (SOUTH WEST)	Site Name:	CHIPPENHAM PHASE 5 AFFORDABLE
House Type:	CLASSIC STORER4B6P RENTED		
Drawing No:	613678__	Revision No:	
Date Drawn:	Thu, Mar 31, 2022	Revision Date:	
Designed By:	SOMMER AL-KHAIAT	Quote No:	

Items on Plan:		Default Style				
Plan No.	Qty	Code	Hdg	Description	Dims	CC (M3)
1	1	BBU6592C		Carcase Matched Base Blender	650/920	
2	1	BU66F	L	Base Unit FH	600/600/870	0.20
3	1	BU66F	R	Base Unit FH	600/600/870	0.20
4	1	BBU6592C		Carcase Matched Base Blender	650/920	
5	1	TSP3X6P		Tray Space	300/600	0.03
6	1	CB106FBBO	L	Corner Base FH, No C/Post (400 Door)	1000/600/870	0.34
7	1	DU56D		Drawer Unit	500/600/870	0.16
8	1	CB86FB	L	Corner Base FH (300 Door)	800/600/870	0.26
9	1	BU46F	R	Base Unit FH	400/600/870	0.13
10	1	BR6623	R	Broom Unit	600/600/2276	0.63
11	1	WU690	L	Wall Unit	600/300/900	0.13
12	1	WU690LK	R	Lockable Wall Unit	600/300/900	0.13
13	1	CWU690	L	Corner Wall (300 Door)	600/300/900	0.13
13.1	1	BBU6592C		Carcase Matched Base Blender **Use With CWU's if Required**	650/920	
14	1	WU390	L	Wall Unit	300/300/900	0.06
15	1	WU490	R	Wall Unit	400/300/900	0.08

Total cubic metres of storage 2.48

Worktop Details:		Default Style		
Plan No.	Qty	Code	Description	Dims
16	1	PF40	40mm P/F Worktop	2700/600
17	1	PF40	40mm P/F Worktop	600/600
18	1	PF40	40mm P/F Worktop	600/600
19	1	PF40	40mm P/F Worktop	1400/600

Accessories and Trims:		Default Style		
Qty	Code	Description	Dims	

3	BRKPLINTH	Plinth Corner Bracket (Pack of 2)	
3	CONPLINTHC	Carcase Matched Continuous Plinth w/Plinth Seal	2600
1	ECOBIN4	Triple Ecobin	400
2	RUNITPROTECT	Kitchen Protective Material	
2	STRIPALP4010	Alum. P/F Strip (10)	40/665mm
3	STRIPALS4010	Alum. P/F End Cap (10)	40/650

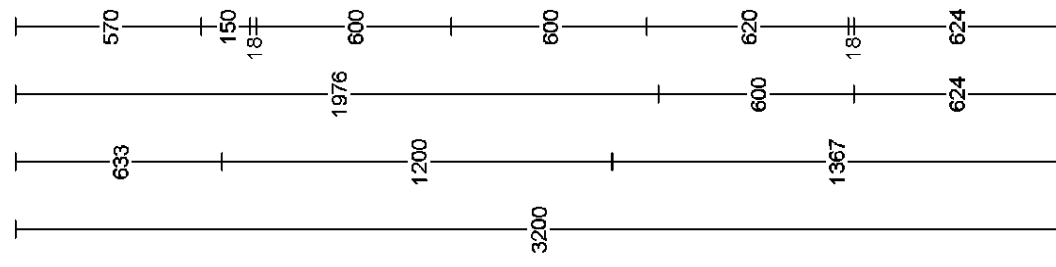
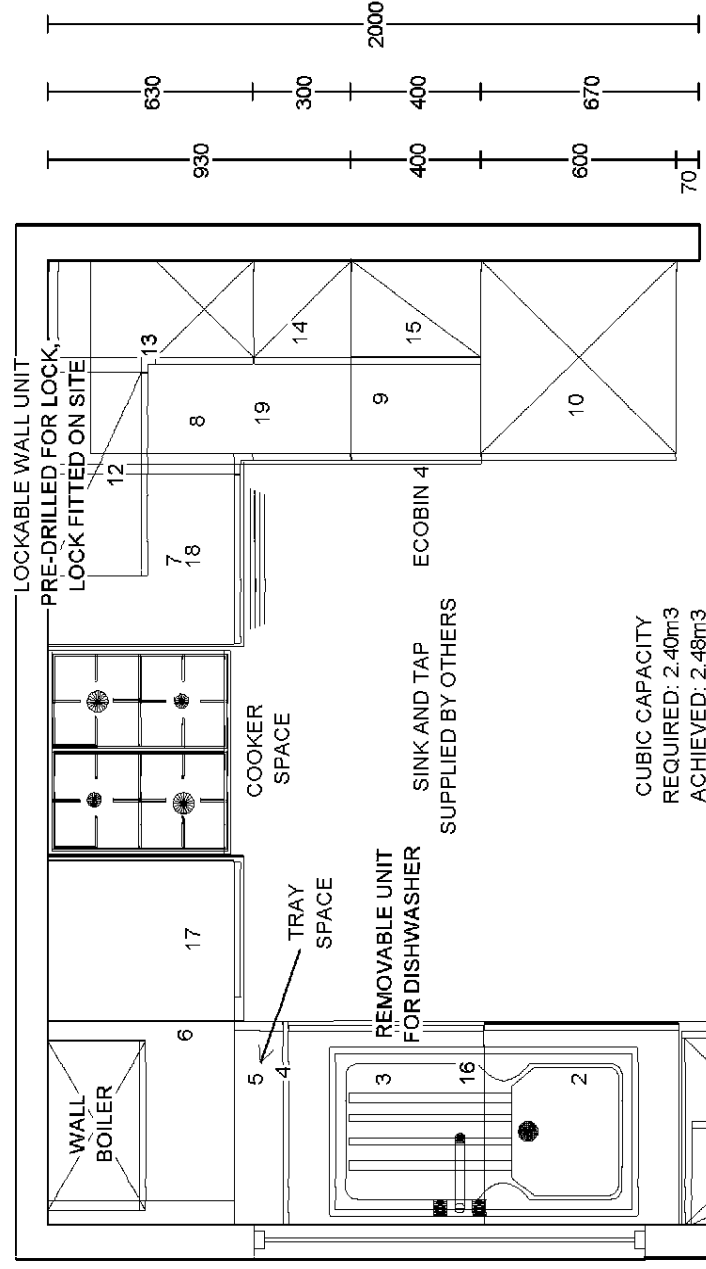
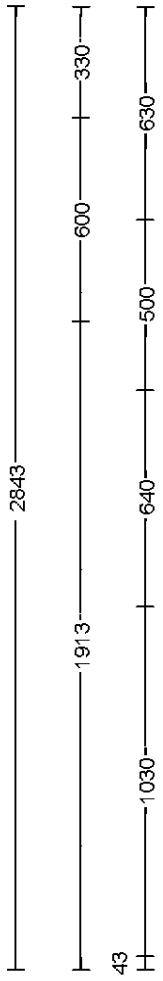

PLEASE CHECK
DIMENSIONS PRIOR TO
ORDER, TAKEN FROM
PARTIALLY UNDIMENSIONED PLANS

CUBIC CAPACITY
REQUIRED: 2.40m³
ACHIEVED: 2.48m³

Client:	BLOOR SWINDON (SOUTH WEST)	Drawing No:	613678
Site:	CHIPPENHAM PHASE 5	Revision No:	
House Type:	CLASSIC STORER4B8P	Scale:	Scale-to-fit
House Type 2:	RENTED		



THIS DRAWING AND THE COPYRIGHT THEREIN IS THE PROPERTY OF THE SYMPHONY GROUP PLC. THIS DRAWING IS ISSUED ON THE CONDITION THAT IT IS NOT TO BE USED, COPIED OR REPRODUCED WITHOUT THE WRITTEN PERMISSION OF THE SYMPHONY GROUP PLC. ANY COPIES OR REPRODUCTIONS OF THIS DRAWING MUST NOT BE USED FOR ANY OTHER PURPOSE THAN FOR WHICH THE DRAWING IS ISSUED. THE PLAN IS OFFERED AS A GUIDE ONLY FOR APPROVAL BY OUR CUSTOMER. NO RESPONSIBILITY IS UNDERTAKEN FOR ITS ACCURACY IN RELATION TO ORDERS PLACED FOR THE FITTING OF OUR GOODS WITHIN THE DIMENSIONS SHOWN.